

### Input data

System of measurement		Metric
Input type		Coupling for electric motor
Input speed	[rpm]	1400
Output speed	[rpm]	50
Ratio (i=)		28
Frequency	[Hz]	50
Input options		IEC
Requested input power	[kW]	0.13
Service factor		1.2
Rated Power P1	[kW]	0.16

### Output data

#### **Gear unit** F RT 28 B3 28 63 B14 AC 14

Type		RT - Worm speed reducers
Input type		F (Elastic coupling)
Size		28
Ratio (i=)		28
Input flange		B14
Input speed	[rpm]	1400
Output speed	[rpm]	50
Rated output torque	[Nm]	16.39
Service Factor		1.2
Efficiency		0.66
Inertia moment	[kgm <sup>2</sup> ]	0.000005

#### **Gear unit configuration**

Output shaft		Hollow output shaft
Fixing		Universal
Version		B3

#### **Output radial and axial loads**

Ball bearings output radial load	[N]	620
Taper bearings output radial load	[N]	930
Ball bearings output axial load	[N]	124
Taper bearings output axial load	[N]	186

#### **Accessories**

Hollow output shaft		AC 14
---------------------	--	-------

#### **Electric motor coupling**

Size		63 A4
Poles n.		4
Power	[kW]	0.13

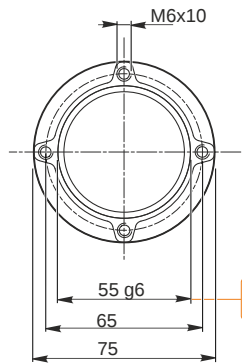
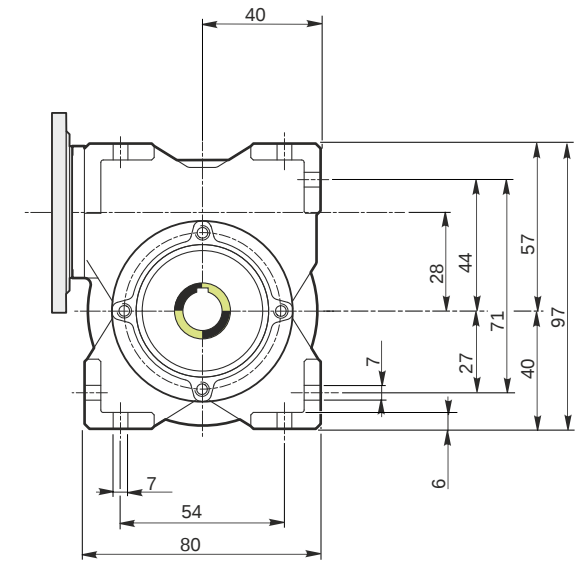
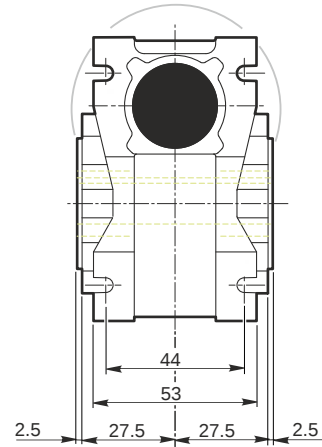
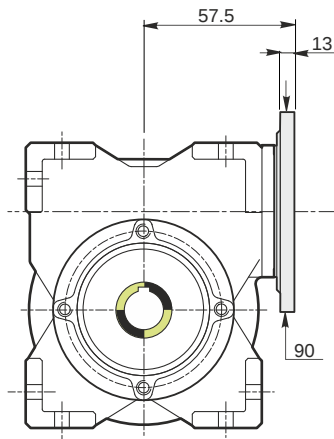

*Hollow output shaft*

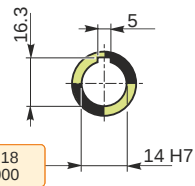

54.99  
54.971

14.018  
14.000

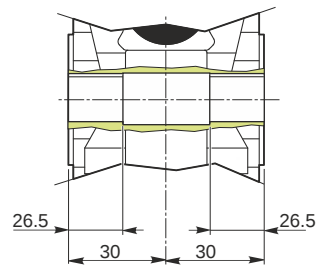

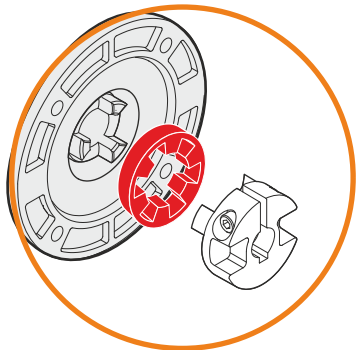
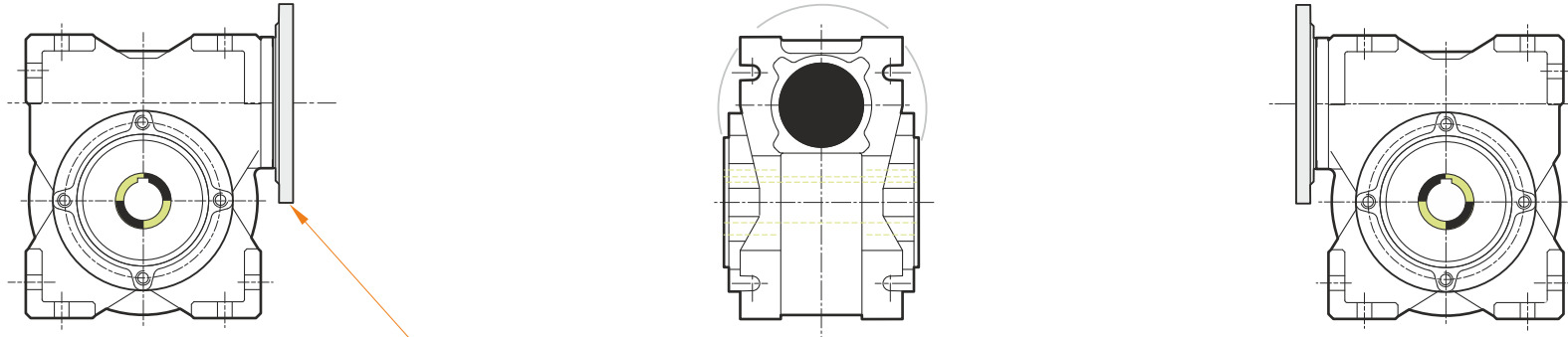

This gear unit is provided with an elastic coupling motor fitting

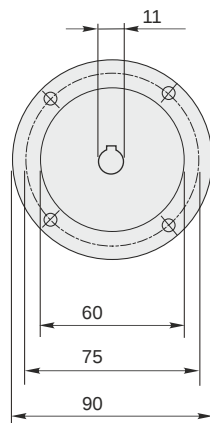

**F RT 28 B3 28 63 B14 AC 14**

**Mounting positions**

**B3**

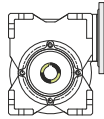

**B6**

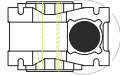

**B7**

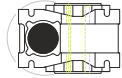

**B8**

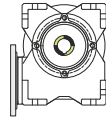

**V5**

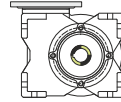

**V6**

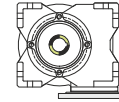

0.03



← Oil quantity [litres]

Lubricant type: Long life synthetic oil ISO VG320

**Direction of rotation**

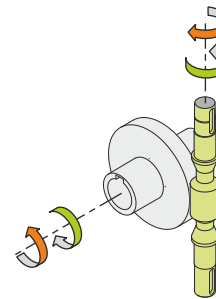
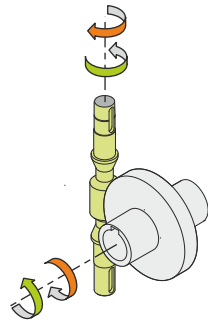
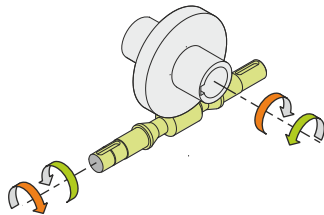

**Weight**

Gear unit [kg] 1.1

**Gearing data**

Axial module	1.5
Number of starts	1
Lead angle	6° 06'
Pressure angle	20°

**Backdriving**

Static self-locking  
Slow back-driving in case of vibrations  
Low dynamic back-driving