

### Input data

System of measurement		Metric
Input type		Coupling for electric motor
Input speed	[rpm]	1400
Output speed	[rpm]	20
Ratio (i=)		70
Frequency	[Hz]	50
Input options		IEC
Requested input power	[kW]	0.13
Service factor		1.1
Rated Power P1	[kW]	0.14

### Output data

#### **Gear unit** F RT 40 B3 70 63 B14 AC 19

Type		RT - Worm speed reducers
Input type		F (Elastic coupling)
Size		40
Ratio (i=)		70
Input flange		B14
Input speed	[rpm]	1400
Output speed	[rpm]	20
Rated output torque	[Nm]	32.28
Service Factor		1.1
Efficiency		0.52
Inertia moment	[kgm <sup>2</sup> ]	0.000018

#### **Gear unit configuration**

Output shaft		Hollow output shaft
Fixing		Universal
Version		B3

#### **Output radial and axial loads**

Ball bearings output radial load	[N]	1900
Taper bearings output radial load	[N]	2600
Ball bearings output axial load	[N]	380
Taper bearings output axial load	[N]	520

#### **Accessories**

Hollow output shaft		AC 19
---------------------	--	-------

#### **Electric motor coupling**

Size		63 A4
Poles n.		4
Power	[kW]	0.13

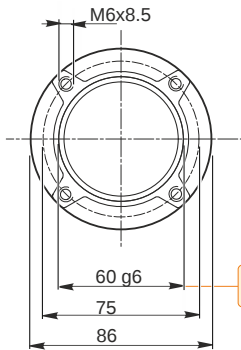
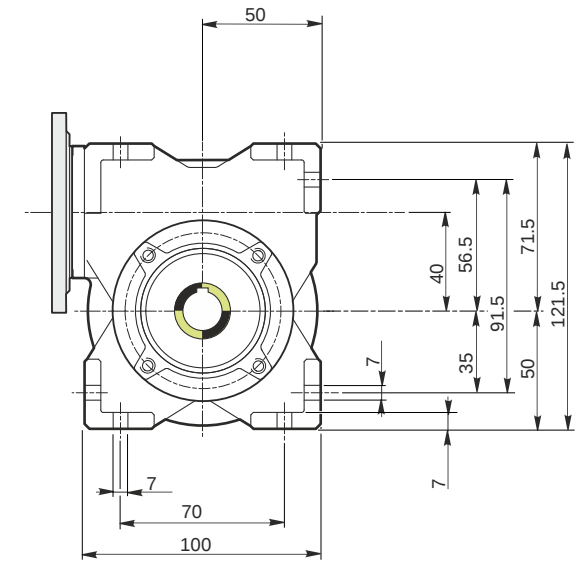
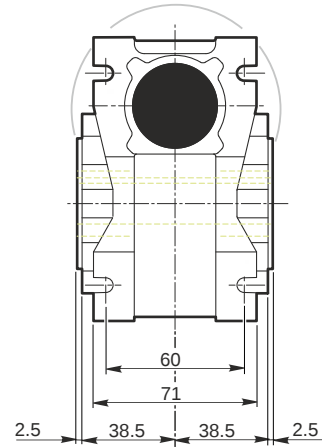
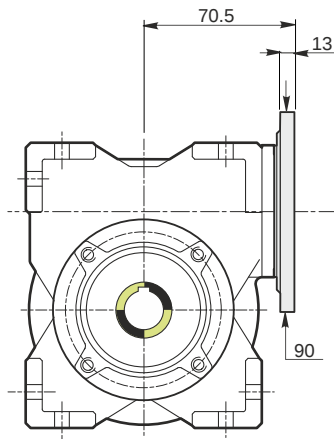

*Hollow output shaft*

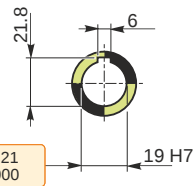

59.99  
59.971

19.021  
19.000

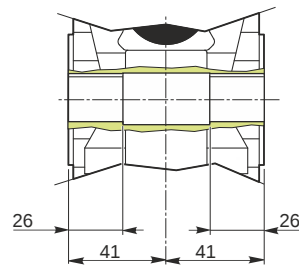

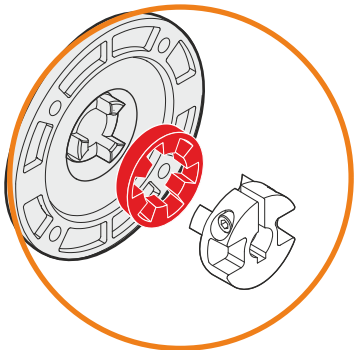
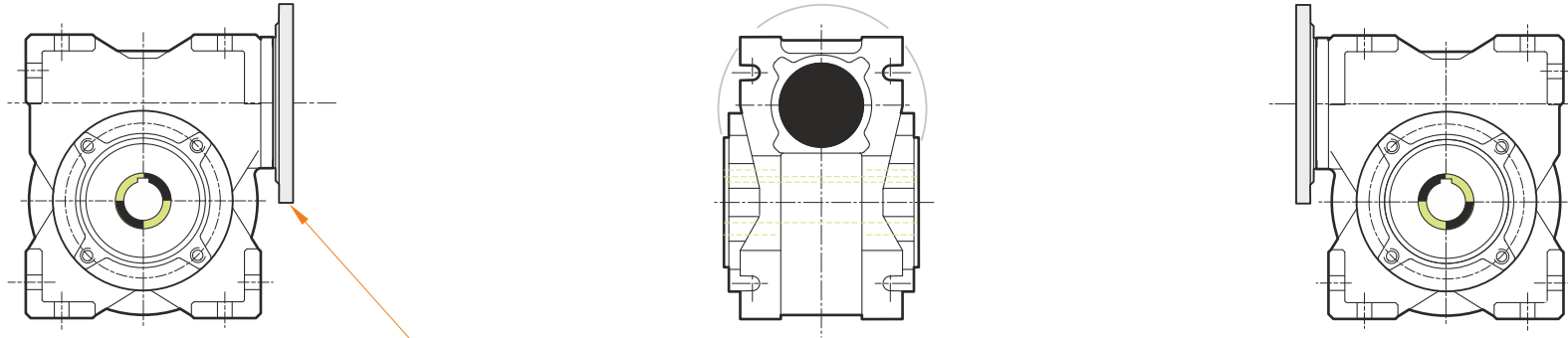

This gear unit is provided with an elastic coupling motor fitting

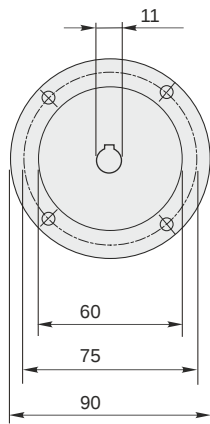

**F RT 40 B3 70 63 B14 AC 19**

**Mounting positions**

**B3**

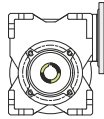

**B6**

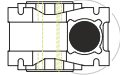

**B7**

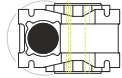

**B8**

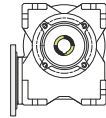

**V5**

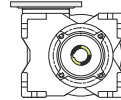

**V6**

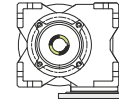

0.08



← Oil quantity [litres]

Lubricant type: Long life synthetic oil ISO VG320

**Direction of rotation**

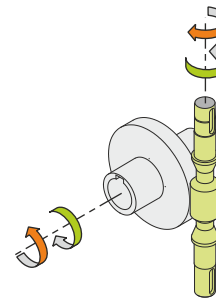
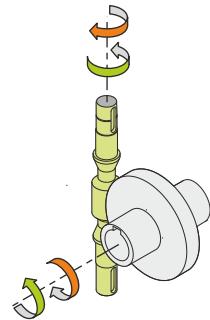
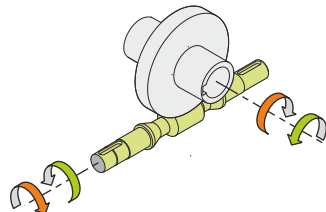
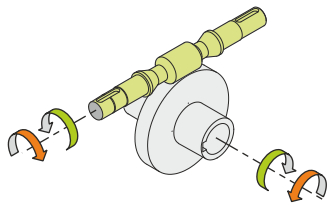

**Weight**

Gear unit [kg] 2.5

**Gearing data**

Axial module 0.9  
Number of starts 1  
Lead angle 3° 01'  
Pressure angle 20°

**Backdriving**

Static self-locking  
Slow back-driving in case of vibrations  
Low dynamic back-driving