

Input data

System of measurement		Metric
Input type		Coupling for electric motor
Input speed	[rpm]	1400
Output speed	[rpm]	200
Ratio (i=)		7
Frequency	[Hz]	50
Input options		IEC
Requested input power	[kW]	3
Service factor		2.1
Rated Power P1	[kW]	6.16

Output data

Gear unit F RT 85 B3 7 100 B14 AC 32

Type		RT - Worm speed reducers
Input type		F (Elastic coupling)
Size		85
Ratio (i=)		7
Input flange		B14
Input speed	[rpm]	1400
Output speed	[rpm]	200
Rated output torque	[Nm]	126.06
Service Factor		2.1
Efficiency		0.88
Inertia moment	[kgm ²]	0.000489

Gear unit configuration

Output shaft		Hollow output shaft
Fixing		Universal
Version		B3

Output radial and axial loads

Ball bearings output radial load	[N]	3300
Taper bearings output radial load	[N]	4200
Ball bearings output axial load	[N]	660
Taper bearings output axial load	[N]	840

Accessories

Hollow output shaft		AC 32
---------------------	--	-------

Electric motor coupling

Size		100 B4
Poles n.		4
Power	[kW]	3

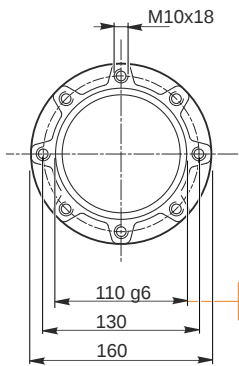
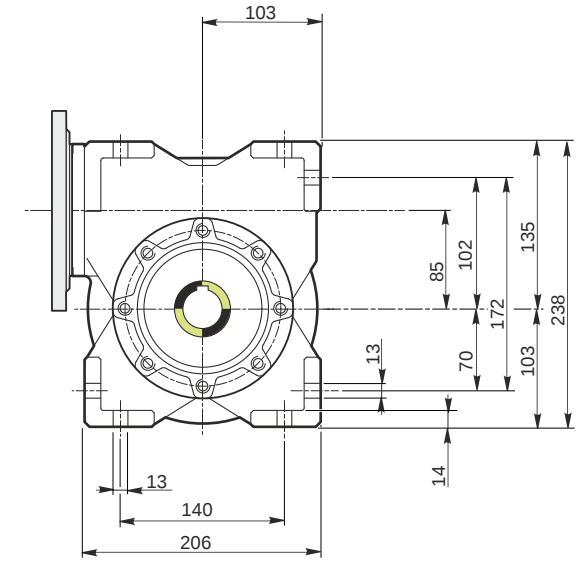
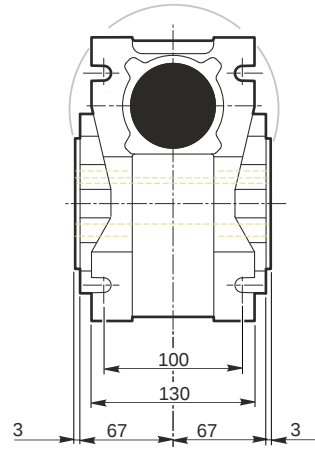
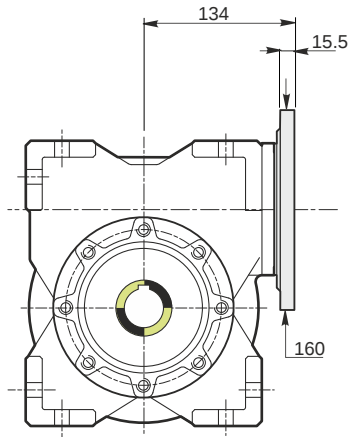

Hollow output shaft

109.988
109.966

32.025
32.000

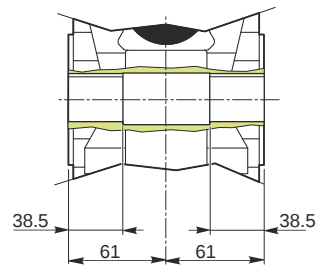
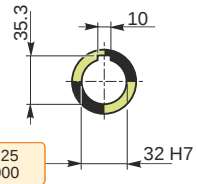

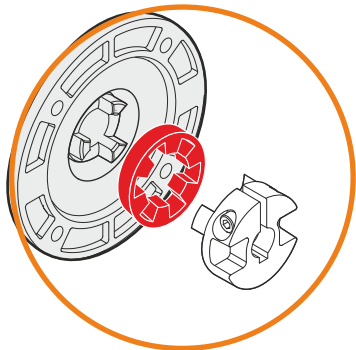
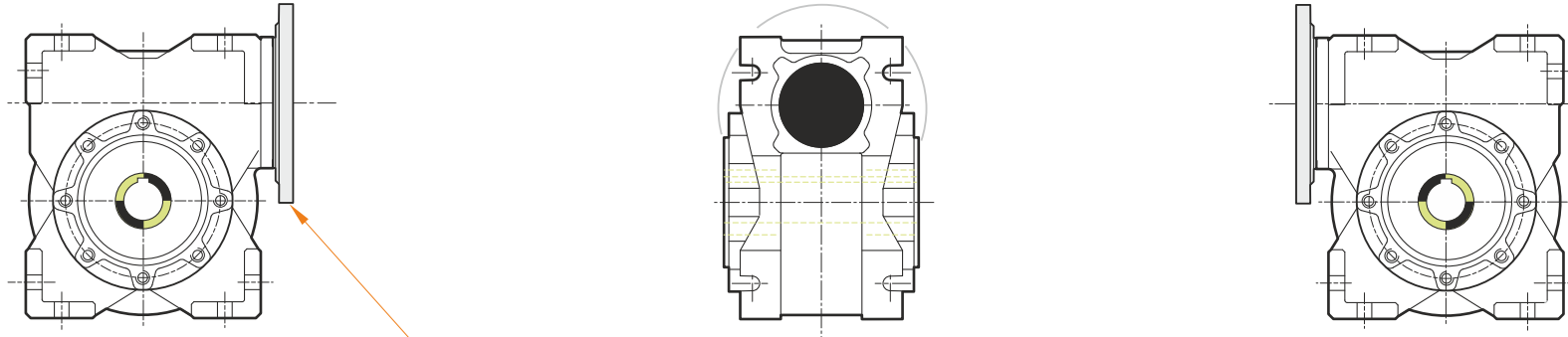

This gear unit is provided with an elastic coupling motor fitting

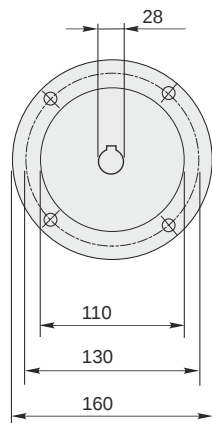

F RT 85 B3 7 100 B14 AC 32

Mounting positions

B3

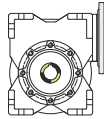

B6

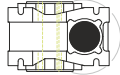

B7

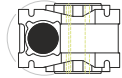

B8

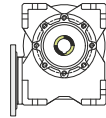

V5

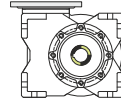

V6

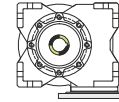

0.6



← Oil quantity [litres]

Lubricant type: Long life synthetic oil ISO VG320

Direction of rotation

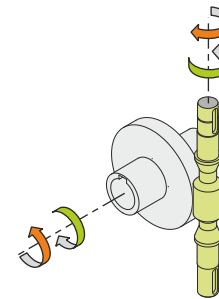
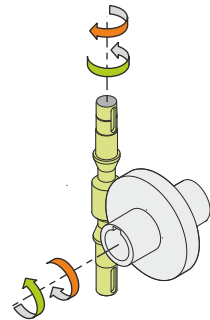
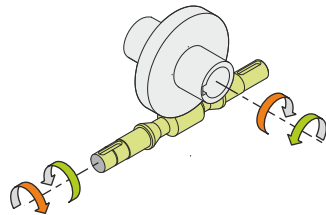
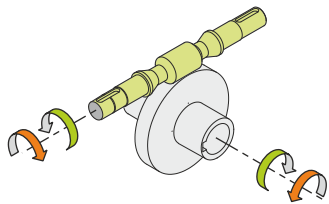

Weight

Gear unit [kg] 13.5

Gearing data

Axial module	4.7
Number of starts	4
Lead angle	26° 05'
Pressure angle	20°

Backdriving

Static back-driving
Quick back-driving
Dynamic back-driving