

### Input data

System of measurement		Metric
Input type		Coupling for electric motor
Input speed	[rpm]	1400
Output speed	[rpm]	140
Ratio (i=)		10
Frequency	[Hz]	50
Input options		IEC
Requested input power	[kW]	3
Service factor		1.5
Rated Power P1	[kW]	4.57

### Output data

#### Gear unit **F RT 85 B3 10 100 B14 AC 32**

Type		RT - Worm speed reducers
Input type		F (Elastic coupling)
Size		85
Ratio (i=)		10
Input flange		B14
Input speed	[rpm]	1400
Output speed	[rpm]	140
Rated output torque	[Nm]	175.99
Service Factor		1.5
Efficiency		0.86
Inertia moment	[kgm <sup>2</sup> ]	0.000413

#### Gear unit configuration

Output shaft		Hollow output shaft
Fixing		Universal
Version		B3

#### Output radial and axial loads

Ball bearings output radial load	[N]	3700
Taper bearings output radial load	[N]	4600
Ball bearings output axial load	[N]	740
Taper bearings output axial load	[N]	920

#### Accessories

Hollow output shaft		AC 32
---------------------	--	-------

#### Electric motor coupling

Size		100 B4
Poles n.		4
Power	[kW]	3

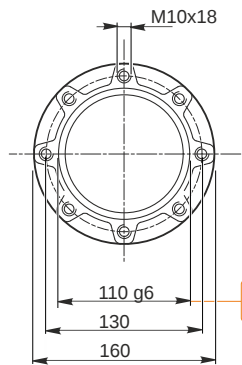
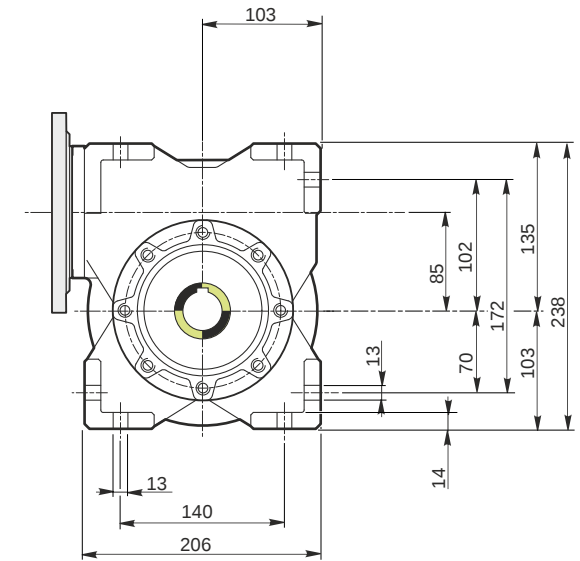
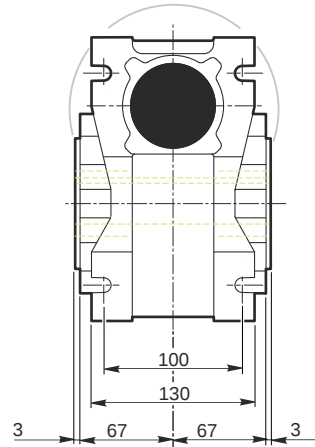
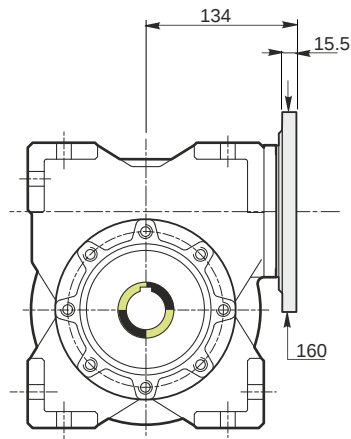

*Hollow output shaft*

109.988  
109.966

32.025  
32.000

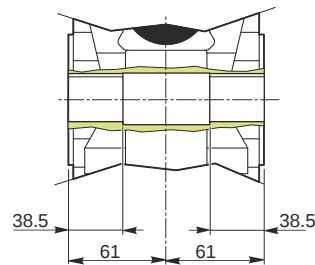
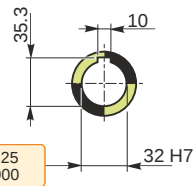

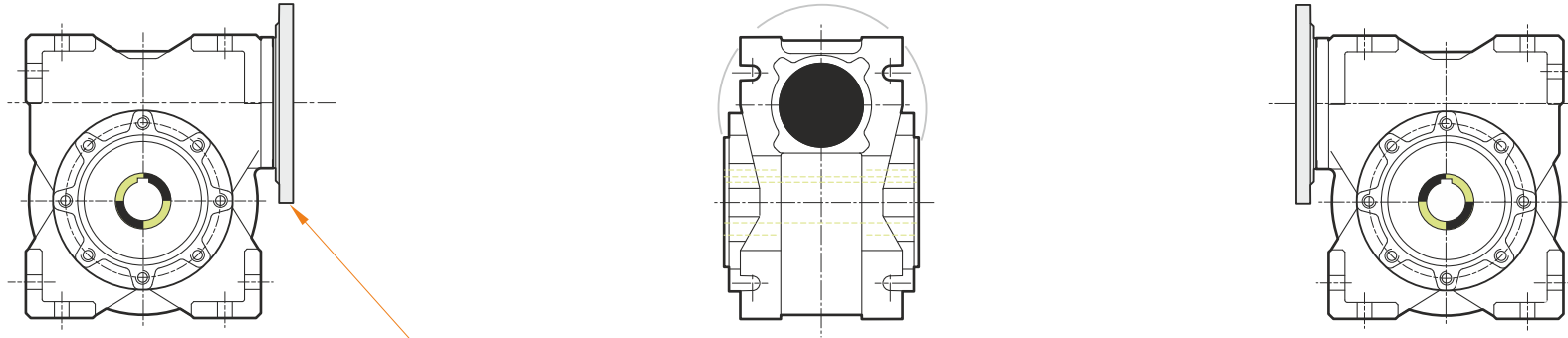

This gear unit is provided with an elastic coupling motor fitting

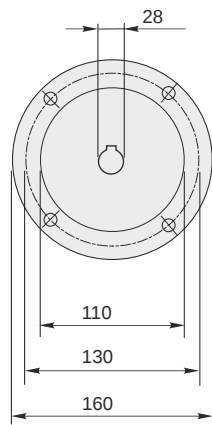

**F RT 85 B3 10 100 B14 AC 32**

**Mounting positions**

**B3**

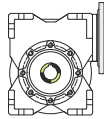

**B6**

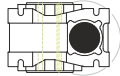

**B7**

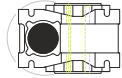

**B8**

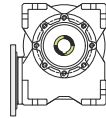

**V5**

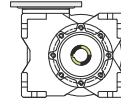

**V6**

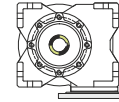

0.6



← Oil quantity [litres]

Lubricant type: Long life synthetic oil ISO VG320

**Direction of rotation**

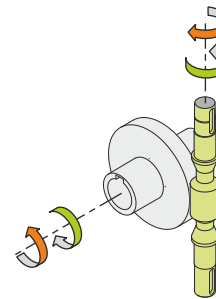
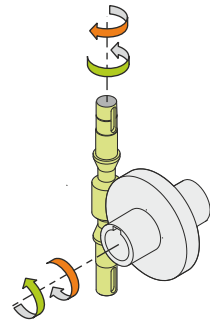
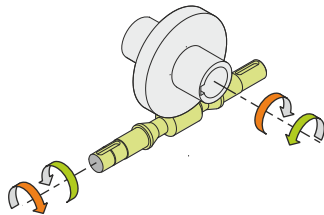

**Weight**

Gear unit [kg] 13.5

**Gearing data**

Axial module 4.4  
Number of starts 3  
Lead angle 19° 09'  
Pressure angle 20°

**Backdriving**

Static back-driving  
Quick back-driving  
Dynamic back-driving