

### Input data

System of measurement		Metric
Input type		Coupling for electric motor
Input speed	[rpm]	1400
Output speed	[rpm]	25
Ratio (i=)		56
Frequency	[Hz]	50
Input options		IEC
Requested input power	[kW]	1.5
Service factor		1.5
Rated Power P1	[kW]	2.23

### Output data

#### **Gear unit** F RT 110 B3 56 90 B5 AC 42

Type		RT - Worm speed reducers
Input type		F
Size		110
Ratio (i=)		56
Input flange		B5
Input speed	[rpm]	1400
Output speed	[rpm]	25
Rated output torque	[Nm]	401.1
Service Factor		1.5
Efficiency		0.7
Inertia moment	[kgm <sup>2</sup> ]	0.001688

#### **Gear unit configuration**

Output shaft		Hollow output shaft
Fixing		Universal
Version		B3

#### **Output radial and axial loads**

Ball bearings output radial load	[N]	7800
Taper bearings output radial load	[N]	11100
Ball bearings output axial load	[N]	1560
Taper bearings output axial load	[N]	2220

#### **Accessories**

Hollow output shaft		AC 42
---------------------	--	-------

#### **Electric motor coupling**

Size		90 L4
Poles n.		4
Power	[kW]	1.5

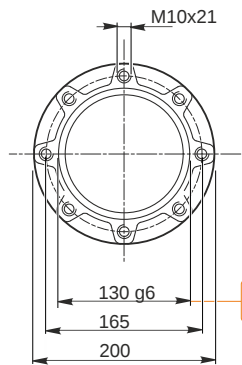
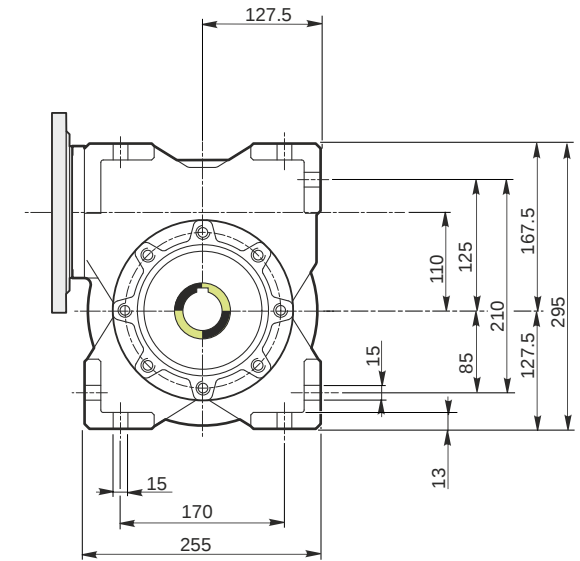
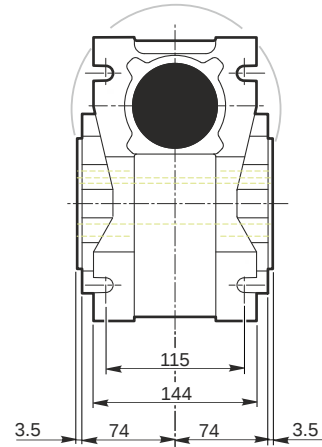
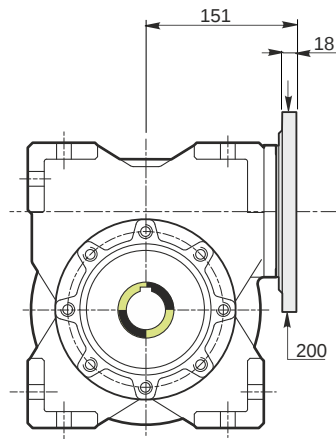

Hollow output shaft

129.986  
129.961

42.025  
42.000

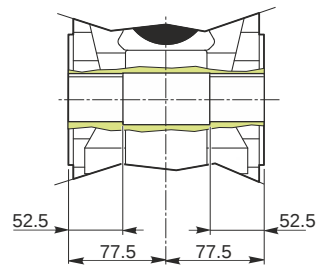
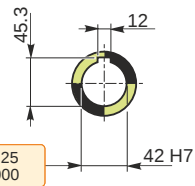

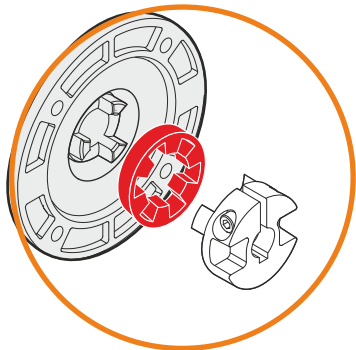
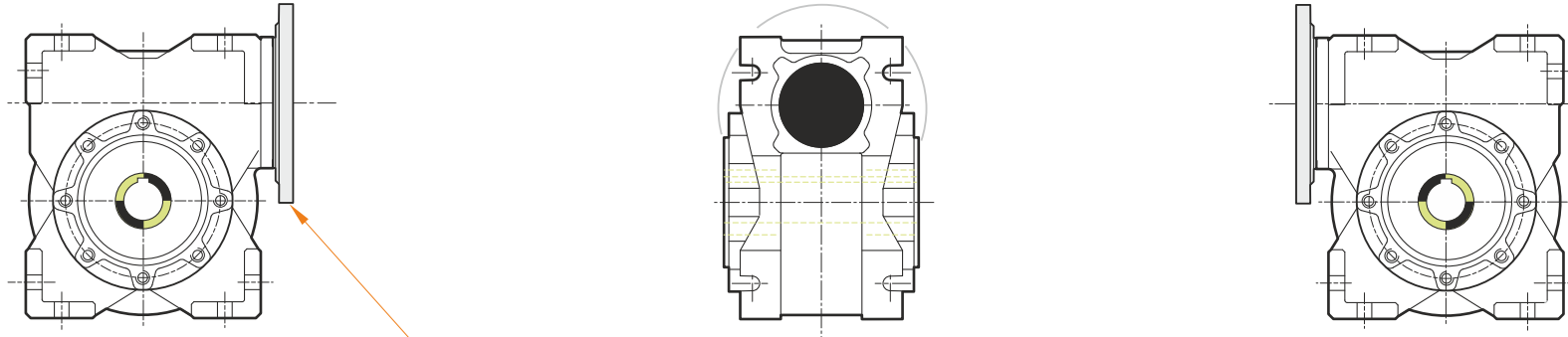

This gear unit is provided with an elastic coupling motor fitting

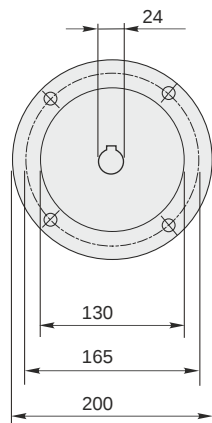

**Mounting positions**

**B3**

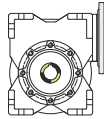

**B6**

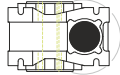

**B7**

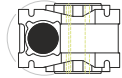

**B8**

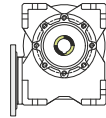

**V5**

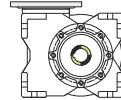

**V6**

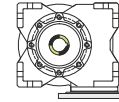

1.5



← Oil quantity [litres]

Lubricant type: Long life synthetic oil ISO VG320

**Direction of rotation**

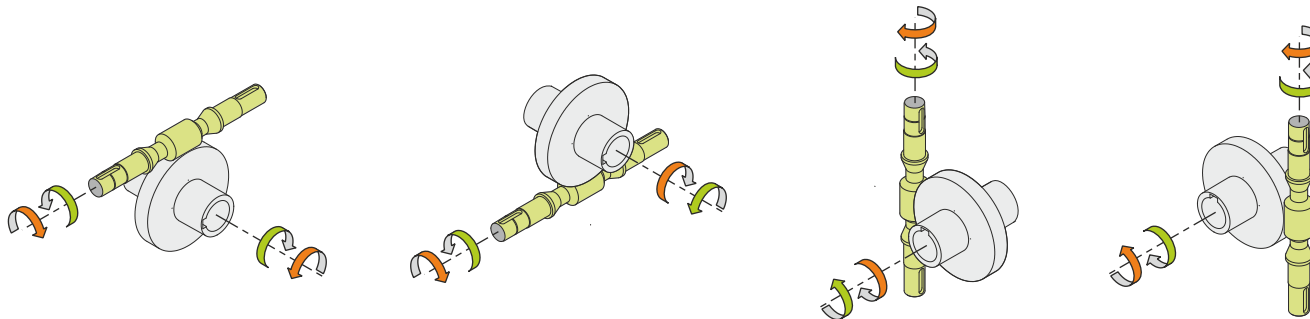

**Weight**

Gear unit [kg] 39

**Gearing data**

Axial module 3.2  
Number of starts 1  
Lead angle 4° 29'  
Pressure angle 20°

**Backdriving**

Static self-locking  
Slow back-driving in case of vibrations  
Low dynamic back-driving