

Input data

System of measurement		Metric
Input type		Coupling for electric motor
Input speed	[rpm]	1400
Output speed	[rpm]	14
Ratio (i=)		100
Frequency	[Hz]	50
Input options		IEC
Requested input power	[kW]	1.1
Service factor		1
Rated Power P1	[kW]	1.13

Output data

Gear unit F RT 110 B3 100 90 B5 AC 42

Type		RT - Worm speed reducers
Input type		F
Size		110
Ratio (i=)		100
Input flange		B5
Input speed	[rpm]	1400
Output speed	[rpm]	14
Rated output torque	[Nm]	457.72
Service Factor		1
Efficiency		0.61
Inertia moment	[kgm ²]	0.001682

Gear unit configuration

Output shaft		Hollow output shaft
Fixing		Universal
Version		B3

Output radial and axial loads

Ball bearings output radial load	[N]	9800
Taper bearings output radial load	[N]	11100
Ball bearings output axial load	[N]	1960
Taper bearings output axial load	[N]	2220

Accessories

Hollow output shaft		AC 42
---------------------	--	-------

Electric motor coupling

Size		90 S4
Poles n.		4
Power	[kW]	1.1

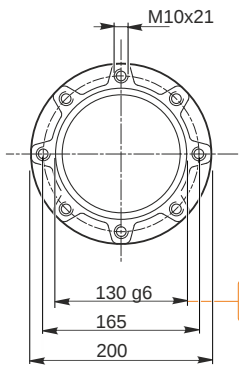
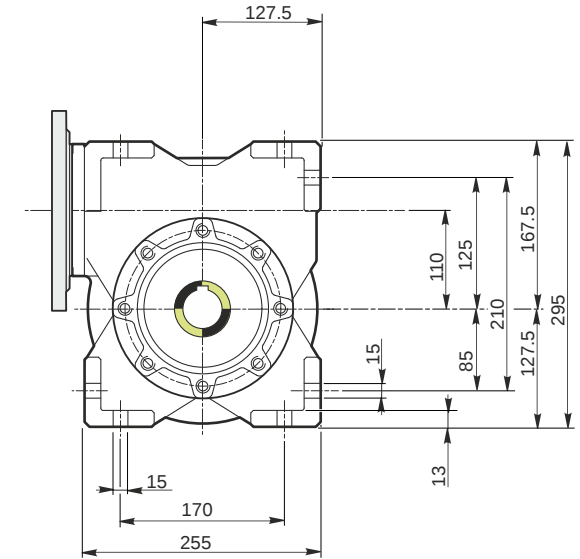
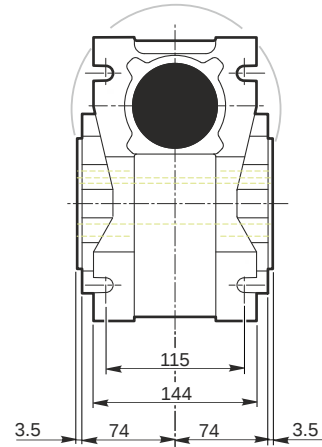
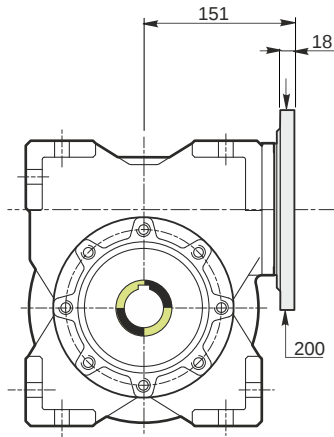

Hollow output shaft

129.986	42.025
129.961	42.000

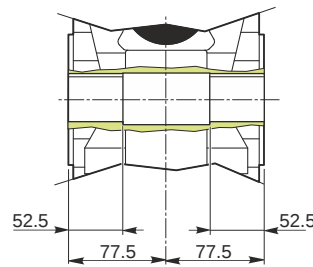
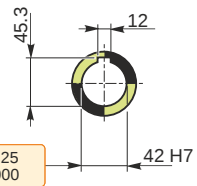

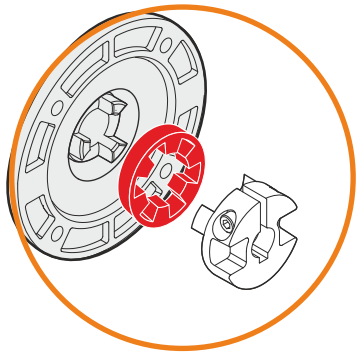
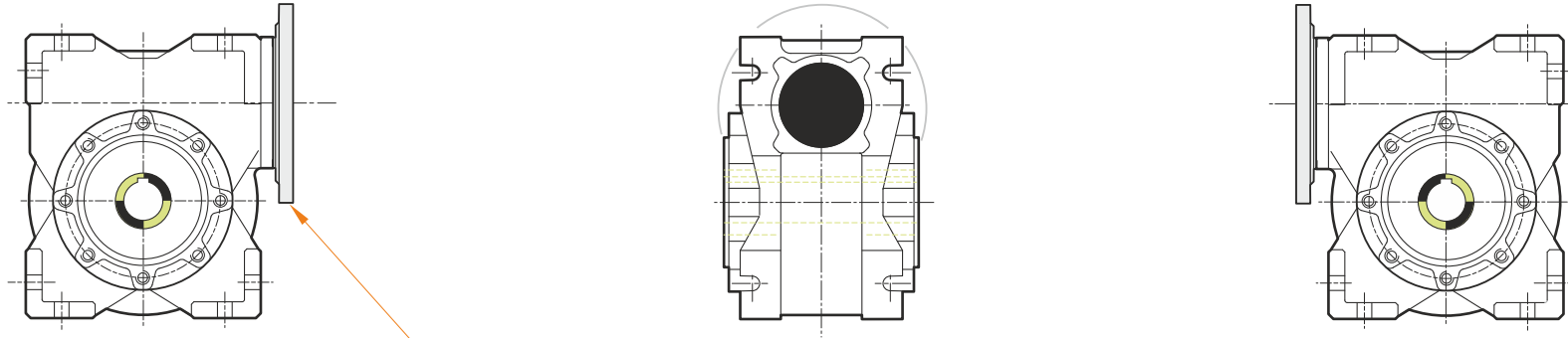

This gear unit is provided with an elastic coupling motor fitting

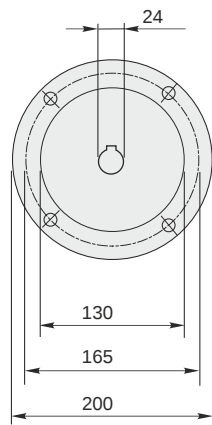

F RT 110 B3 100 90 B5 AC 42

Mounting positions

B3

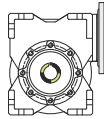

B6

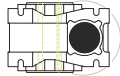

B7

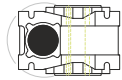

B8

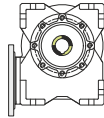

V5

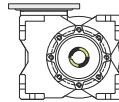

V6

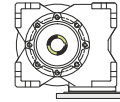

1.5



← Oil quantity [litres]

Lubricant type: Long life synthetic oil ISO VG320

Direction of rotation

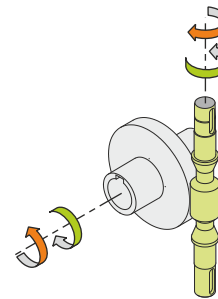
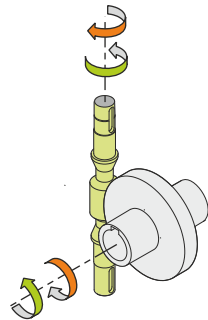
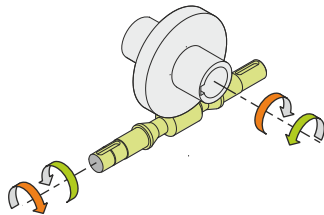
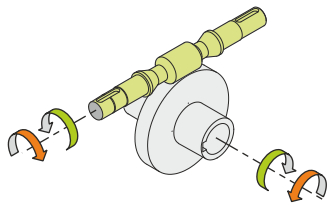

Weight

Gear unit [kg] 39

Gearing data

Axial module 1.8
Number of starts 1
Lead angle 2° 34'
Pressure angle 20°

Backdriving

Static self-locking
No back-driving
Low dynamic back-driving