

### Input data

System of measurement		Metric
Input type		Coupling for electric motor
Input speed	[rpm]	1400
Output speed	[rpm]	25
Ratio (i=)		56
Frequency	[Hz]	50
Input options		IEC
Requested input power	[kW]	3
Service factor		1.2
Rated Power P1	[kW]	3.71

### Output data

#### **Gear unit** F RS 130 PC 56 100 B14 AC 48 B3

Type		RS - Worm speed reducers
Input type		F
Size		130
Ratio (i=)		56
Input flange		B14
Mounting position		B3
Input speed	[rpm]	1400
Output speed	[rpm]	25
Rated output torque	[Nm]	813.66
Service Factor		1.2
Efficiency		0.71
Inertia moment	[kgm <sup>2</sup> ]	0.002666

#### **Gear unit configuration**

Output shaft		Hollow output shaft
Fixing		Shaft mounting
Version		PC

#### **Output radial and axial loads**

Ball bearings output radial load	[N]	9500
Taper bearings output radial load	[N]	14200
Ball bearings output axial load	[N]	1900
Taper bearings output axial load	[N]	2840

#### **Accessories**

Hollow output shaft		AC 48
---------------------	--	-------

#### **Electric motor coupling**

Size		100 B4
Poles n.		4
Power	[kW]	3

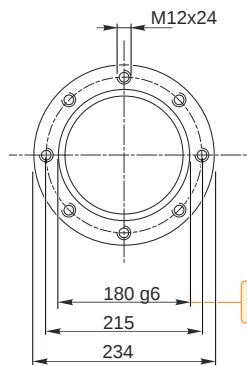
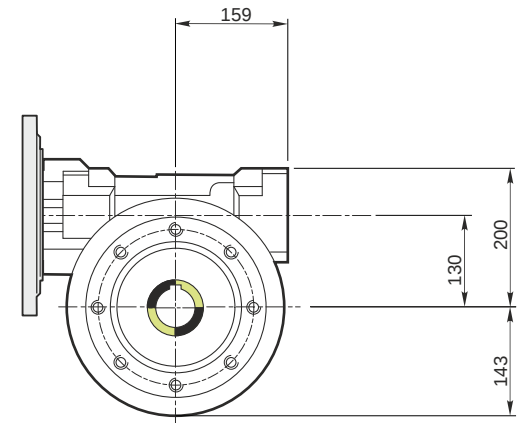
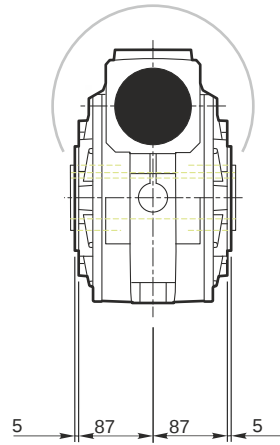
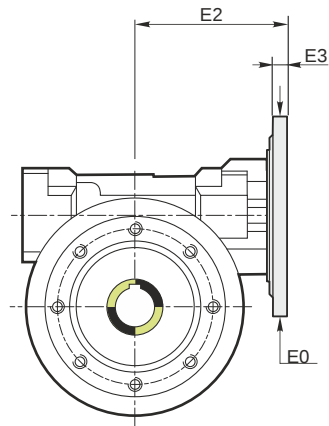

Hollow output shaft

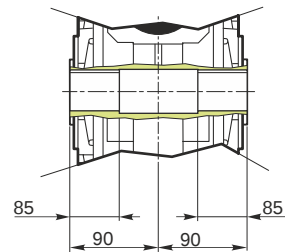
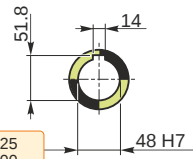

179.986  
179.961

48.025  
48.000

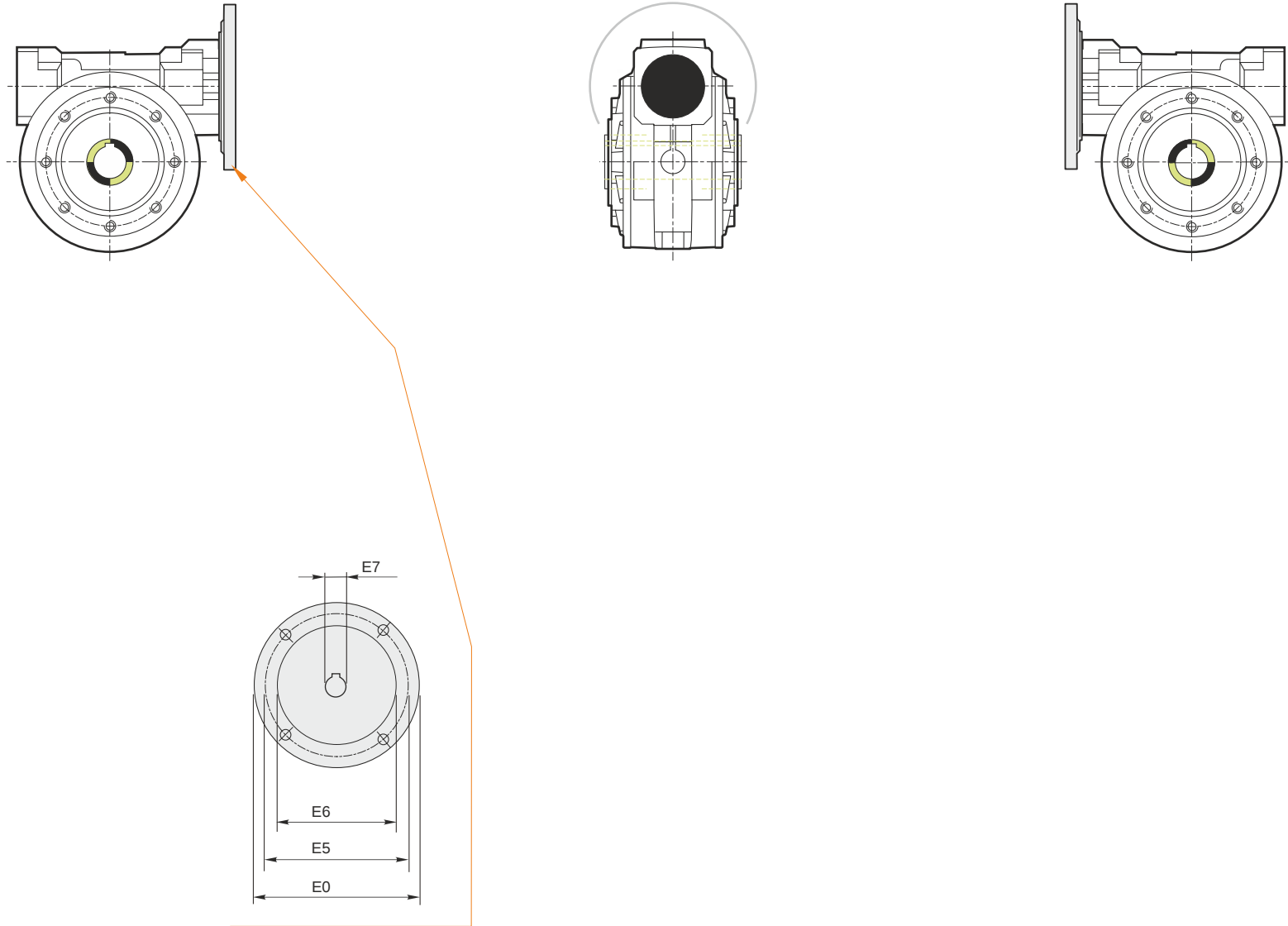

### Mounting positions

B3

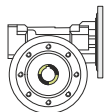

B6

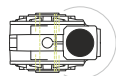

B7

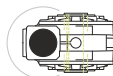

B8

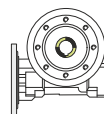

V5

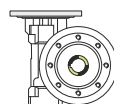

V6

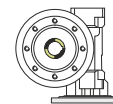

2.75



← Oil quantity [litres]

Lubricant type: Long life synthetic oil ISO VG320

### Direction of rotation

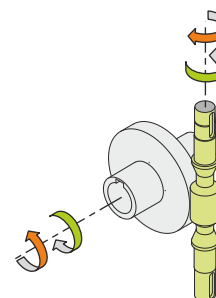
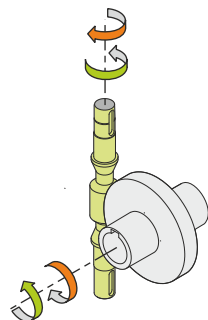
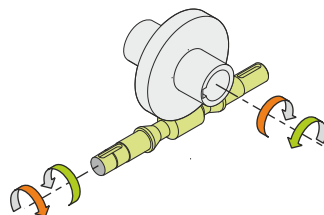
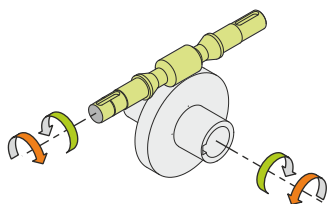

### Weight

Gear unit [kg] 50

### Gearing data

Axial module	4.00
Number of starts	1
Lead angle	6° 20'
Pressure angle	20°

### Backdriving

Static self-locking  
Slow back-driving in case of vibrations  
Low dynamic back-driving