

### Input data

System of measurement		Metric
Input type		Coupling for electric motor
Input speed	[rpm]	1400
Output speed	[rpm]	14
Ratio (i=)		100
Frequency	[Hz]	50
Input options		IEC
Requested input power	[kW]	2.2
Service factor		0.8
Rated Power P1	[kW]	1.8

### Output data

#### **Gear unit** F RS 130 PC 100 100 B14 AC 48 B3

Type		RS - Worm speed reducers
Input type		F
Size		130
Ratio (i=)		100
Input flange		B14
Mounting position		B3
Input speed	[rpm]	1400
Output speed	[rpm]	14
Rated output torque	[Nm]	915.44
Service Factor		0.8
Efficiency		0.61
Inertia moment	[kgm <sup>2</sup> ]	0.002652

#### **Gear unit configuration**

Output shaft		Hollow output shaft
Fixing		Shaft mounting
Version		PC

#### **Output radial and axial loads**

Ball bearings output radial load	[N]	11500
Taper bearings output radial load	[N]	14500
Ball bearings output axial load	[N]	2300
Taper bearings output axial load	[N]	2900

#### **Accessories**

Hollow output shaft		AC 48
---------------------	--	-------

#### **Electric motor coupling**

Size		100 A4
Poles n.		4
Power	[kW]	2.2

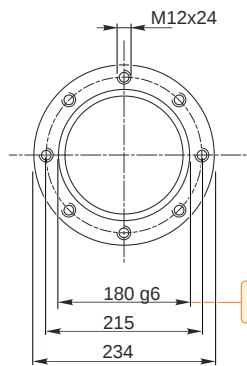
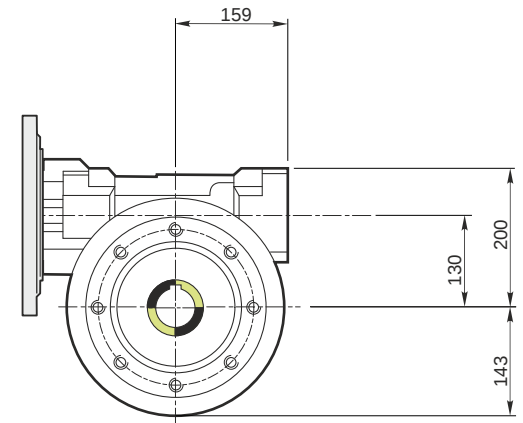
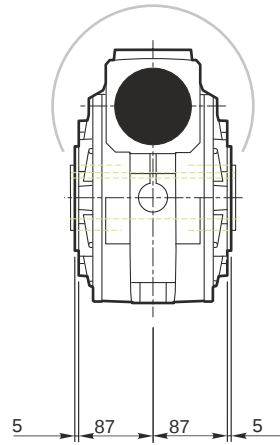
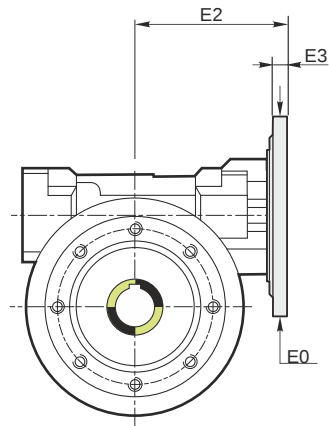

Hollow output shaft

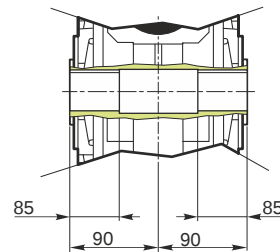
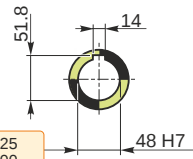

179.986  
179.961

48.025  
48.000

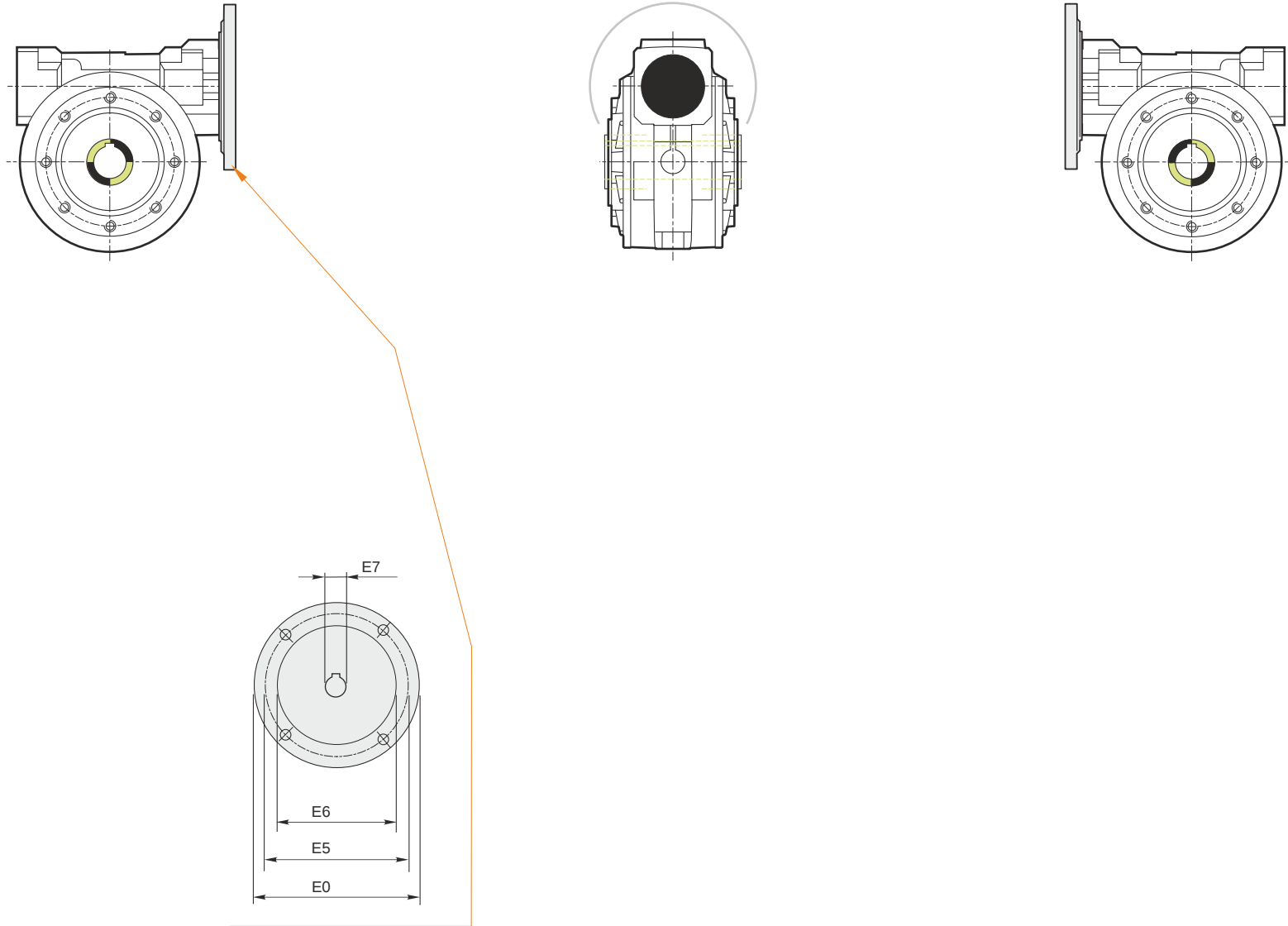

**Mounting positions**

**B3**

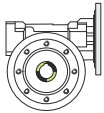

**B6**



**B7**



**B8**

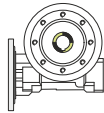

**V5**

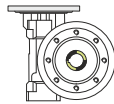

**V6**

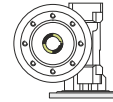

2.75



← Oil quantity [litres]

Lubricant type: Long life synthetic oil ISO VG320

**Direction of rotation**

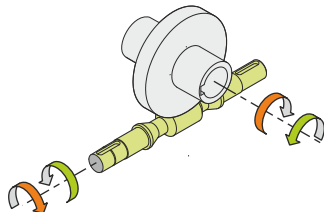

**Weight**

Gear unit [kg] 50

**Gearing data**

Axial module	2.25
Number of starts	1
Lead angle	3° 40'
Pressure angle	20°

**Backdriving**

Static self-locking  
Slow back-driving in case of vibrations  
Low dynamic back-driving