

### Input data

System of measurement		Metric
Input type		Gear motor
Input speed	[rpm]	1400
Output speed	[rpm]	70
Ratio (i=)		20
Frequency	[Hz]	50
Input options		IEC
Requested input power	[kW]	0.25
Service factor		1.5
Rated Power P1	[kW]	0.38

### Output data

**Gear unit** **M RS 40 PC 20 71 B14 AC 19 MT 0.25 kW 71 A4 B14 X3 B3**

Type		RS - Worm speed reducers
Input type		M
Size		40
Ratio (i=)		20
Input flange		B14
Mounting position		B3
Input speed	[rpm]	1400
Output speed	[rpm]	70
Rated output torque	[Nm]	25.58
Service Factor		1.5
Efficiency		0.75
Inertia moment	[kgm <sup>2</sup> ]	0.000019

#### Gear unit configuration

Output shaft		Hollow output shaft
Fixing		Shaft mounting
Version		PC

#### Output radial and axial loads

Ball bearings output radial load	[N]	1350
Taper bearings output radial load	[N]	1900
Ball bearings output axial load	[N]	270
Taper bearings output axial load	[N]	380

#### Accessories

Hollow output shaft		AC 19
---------------------	--	-------

#### Electric motor

Size		71 A4
Poles		4
Power	[kW]	0.25

#### Electric motor configuration

Motor flange		B14
Terminal box position		X3

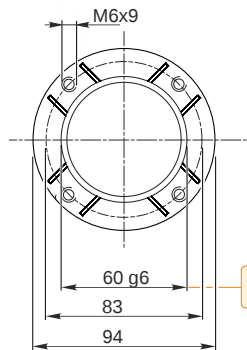
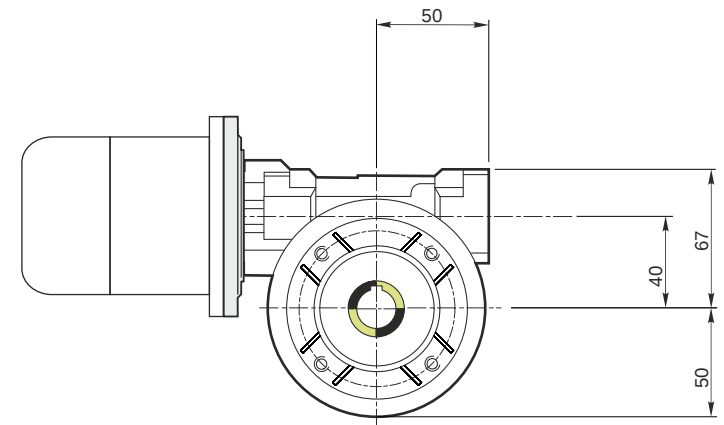
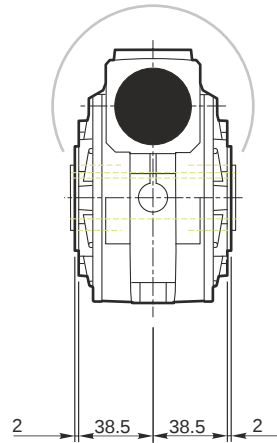
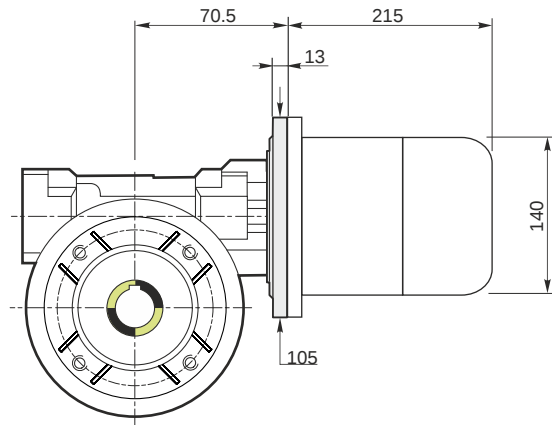

Hollow output shaft

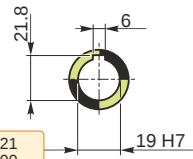

59.99  
59.971

19.021  
19.000

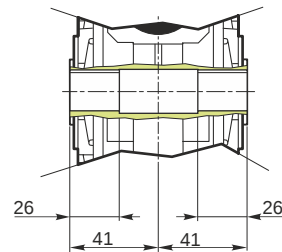

**Mounting positions**

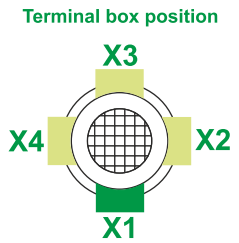
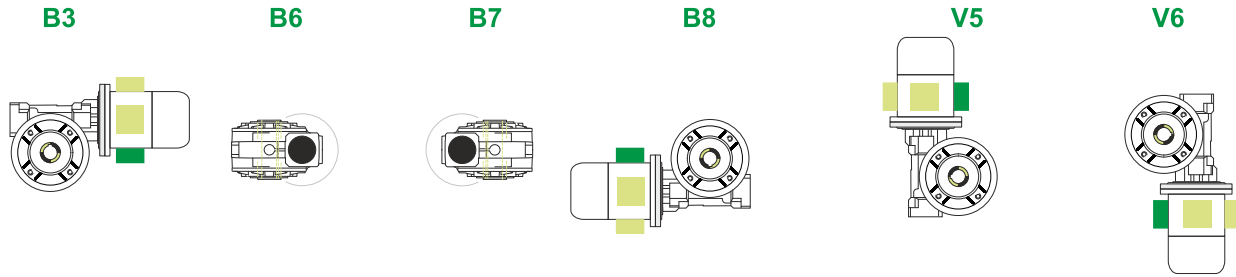

0.08



← Oil quantity [litres]

Lubricant type: Long life synthetic oil ISO VG320

**Direction of rotation**



**Weight**

Gear unit [kg]	2.5
Electric motor [kg]	6.2

**Gearing data**

Axial module	1.5
Number of starts	2
Lead angle	8° 31'
Pressure angle	20°

**Backdriving**

Variable static self-locking  
Quick back-driving in case of vibrations  
Dynamic back-driving

**M RS 40 PC 20 71 B14 AC 19 MT 0.25 kW 71 A4 B14 X3 B3**