

Input data

| | | |
|-----------------------|-------|------------|
| System of measurement | | Metric |
| Input type | | Gear motor |
| Input speed | [rpm] | 1400 |
| Output speed | [rpm] | 14 |
| Ratio (i=) | | 100 |
| Frequency | [Hz] | 50 |
| Input options | | IEC |
| Requested input power | [kW] | 0.13 |
| Service factor | | 1 |
| Rated Power P1 | [kW] | 0.13 |

Output data

Gear unit **M RS 50 PC 100 63 B14 AC 24 MT 0.13 kW 63 A4 B14 X3 B3**

| | | |
|---------------------|---------------------|--------------------------|
| Type | | RS - Worm speed reducers |
| Input type | | M |
| Size | | 50 |
| Ratio (i=) | | 100 |
| Input flange | | B14 |
| Mounting position | | B3 |
| Input speed | [rpm] | 1400 |
| Output speed | [rpm] | 14 |
| Rated output torque | [Nm] | 41.68 |
| Service Factor | | 1 |
| Efficiency | | 0.47 |
| Inertia moment | [kgm ²] | 0.000047 |

Gear unit configuration

| | | |
|--------------|--|---------------------|
| Output shaft | | Hollow output shaft |
| Fixing | | Shaft mounting |
| Version | | PC |

Output radial and axial loads

| | | |
|-----------------------------------|-----|------|
| Ball bearings output radial load | [N] | 3200 |
| Taper bearings output radial load | [N] | 4200 |
| Ball bearings output axial load | [N] | 640 |
| Taper bearings output axial load | [N] | 840 |

Accessories

| | | |
|---------------------|--|-------|
| Hollow output shaft | | AC 24 |
|---------------------|--|-------|

Electric motor

| | | |
|-------|------|-------|
| Size | | 63 A4 |
| Poles | | 4 |
| Power | [kW] | 0.13 |

Electric motor configuration

| | | |
|-----------------------|--|-----|
| Motor flange | | B14 |
| Terminal box position | | X3 |

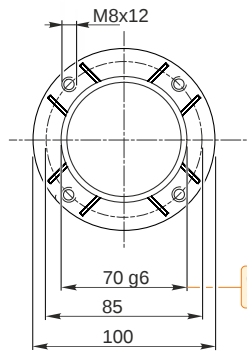
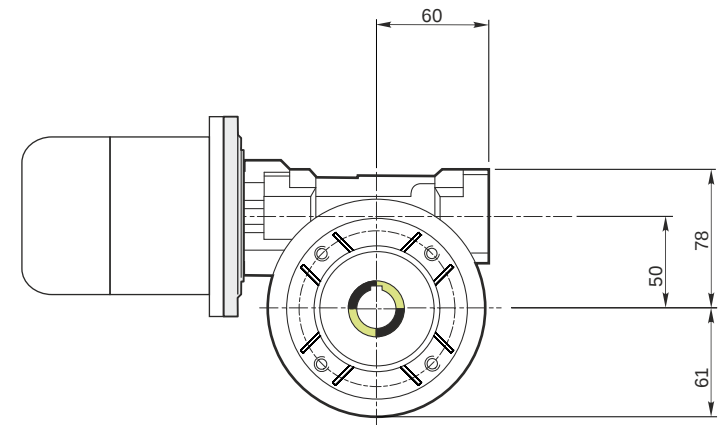
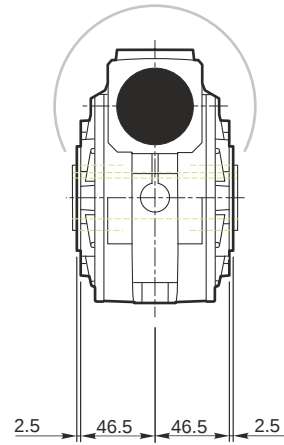
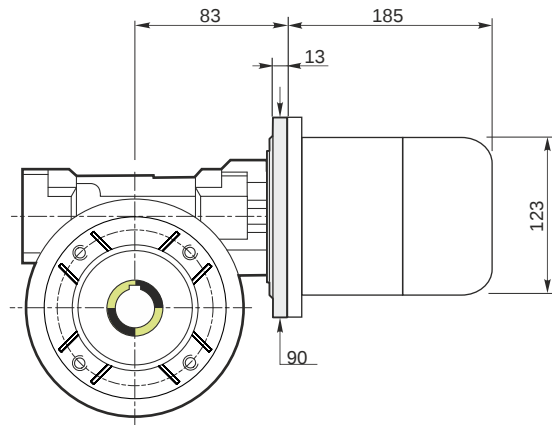

Hollow output shaft

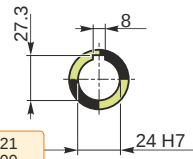

69.99
69.971

24.021
24.000

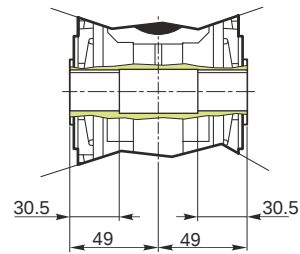

Mounting positions

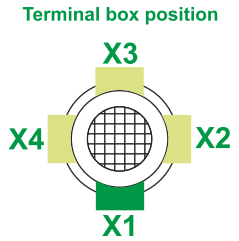
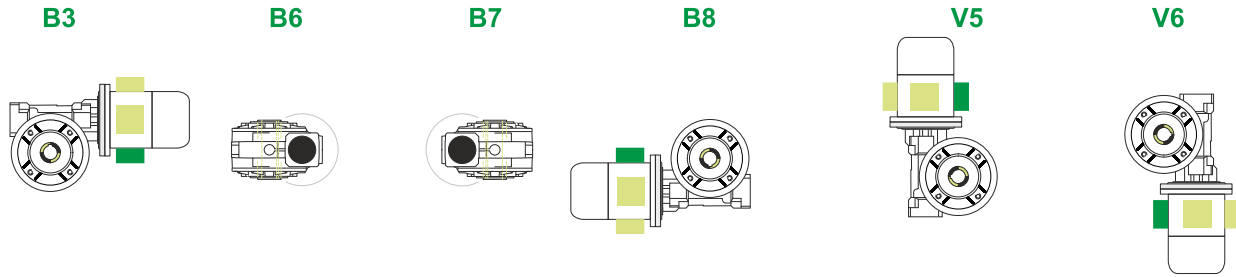

0.13



← Oil quantity [litres]

Lubricant type: Long life synthetic oil ISO VG320

Direction of rotation

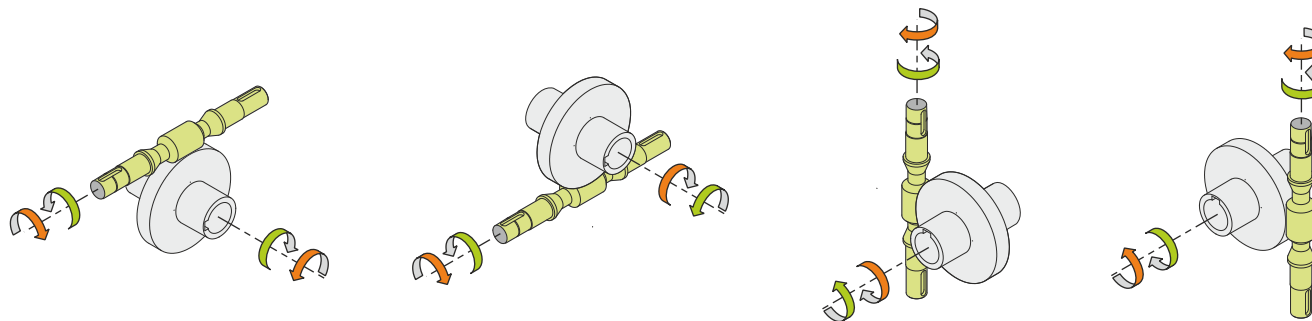

Weight

| | |
|---------------------|-----|
| Gear unit [kg] | 3.8 |
| Electric motor [kg] | 4.3 |

Gearing data

| | |
|------------------|--------|
| Axial module | 0.8 |
| Number of starts | 1 |
| Lead angle | 2° 17' |
| Pressure angle | 20° |

Backdriving

Static self-locking
No back-driving
Low dynamic back-driving

M RS 50 PC 100 63 B14 AC 24 MT 0.13 kW 63 A4 B14 X3 B3