

Input data

System of measurement		Metric
Input type		Gear motor
Input speed	[rpm]	1400
Output speed	[rpm]	0.35
Ratio (i=)		4000
Frequency	[Hz]	50
Input options		IEC
Requested input power	[kW]	0.09
Service factor		1
Rated Power P1	[kW]	0.01

Output data

Gear unit	M RT/RT 40/85 B3 21 4000 56 B5 AC 32 MT 0.09 kW 56 B4 B5 X3
------------------	--

Type		RT/RT - Worm speed reducers
Input type		M
Size		40/85
Ratio (i=)		4000
Gearbox ratio		40.00
Pre-stage ratio		100.00
Input flange		B5
Input speed	[rpm]	1400
Output speed	[rpm]	0.35
Rated output torque	[Nm]	564.81
Service Factor		1
Efficiency		0.23

Gear unit configuration

Output shaft		Hollow output shaft
Fixing		Universal
Version		B3
Attachment position		21

Output radial and axial loads

Ball bearings output radial load	[N]	8300
Taper bearings output radial load	[N]	9400
Ball bearings output axial load	[N]	1660
Taper bearings output axial load	[N]	1880

Accessories

Hollow output shaft		AC 32
---------------------	--	-------

Electric motor

Size		56 B4
Poles		4
Power	[kW]	0.09

Electric motor configuration

Motor flange		B5
Terminal box position		X3

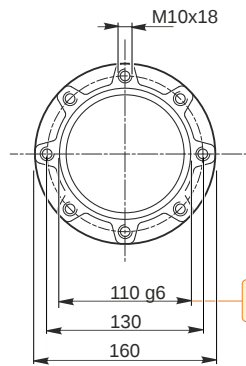
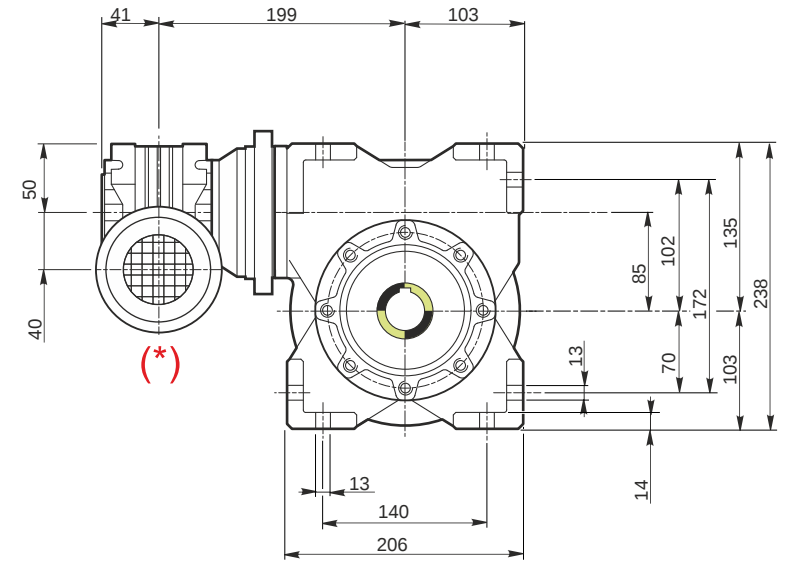
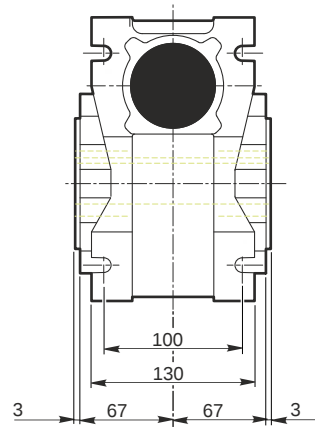
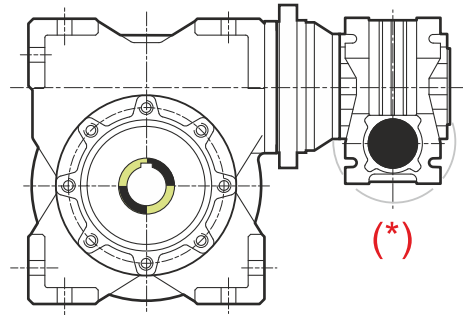

Hollow output shaft

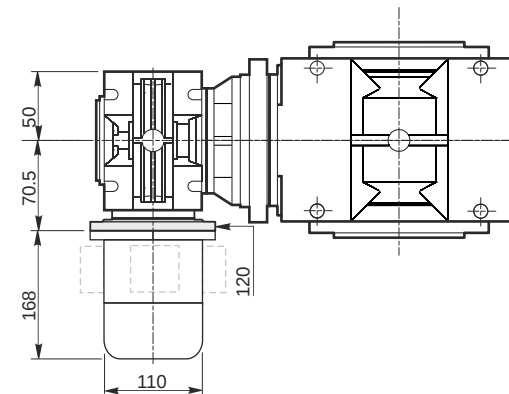
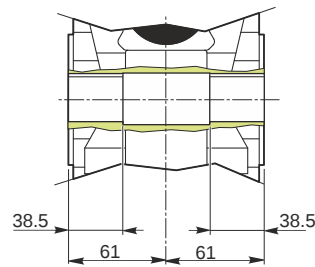
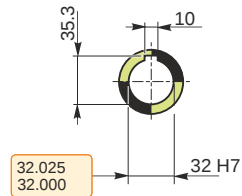

Mounting positions

B3

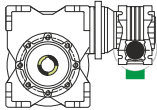

B6

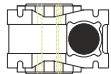

B7

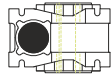

B8

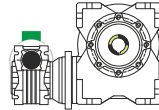

V5

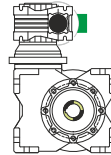

V6

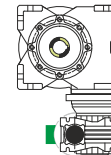

Terminal box position

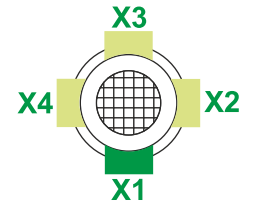

0.08

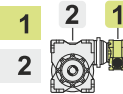

Oil quantity [litres]

0.6

Lubricant type: Long life synthetic oil ISO VG320

Attachment position

20
(std)

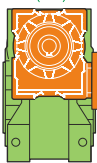
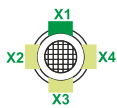

26

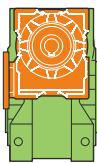
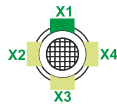

21

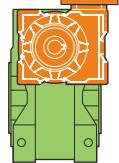
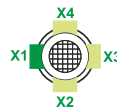

25

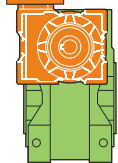
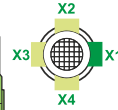

22

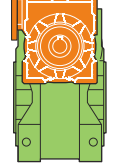
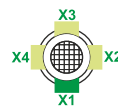

24

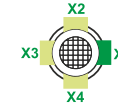
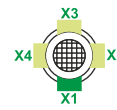

23

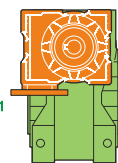

27

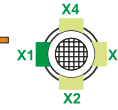
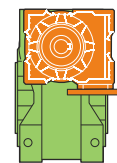

Direction of rotation

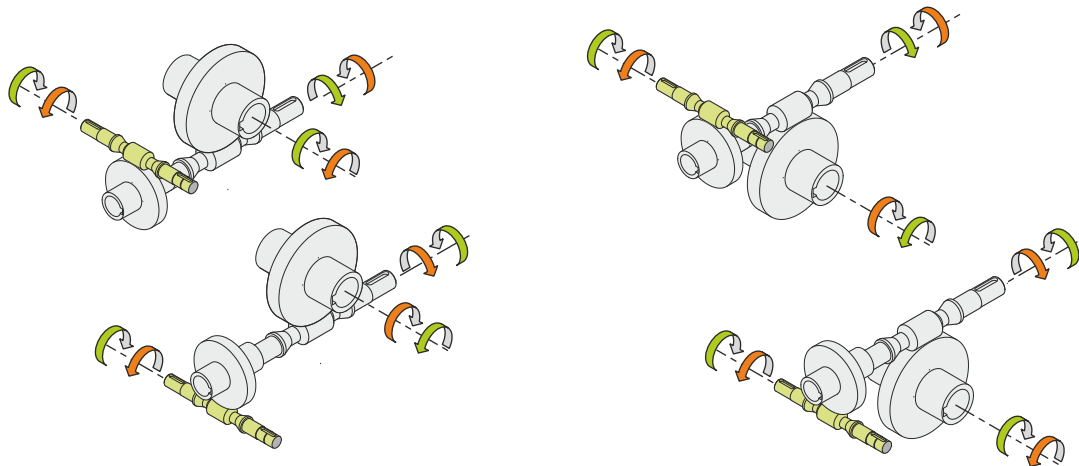

Weight

Gear unit [kg]	16.5
Electric motor [kg]	2.6

Gearing data



Axial module	3.4
Number of starts	1
Lead angle	5° 52'
Pressure angle	20°

Backdriving

- Static self-locking
- No back-driving
- No dynamic back-driving

M RT/RT 40/85 B3 21 4000 56 B5 AC 32 MT 0.09 kW 56 B4 B5 X3