

Input data

System of measurement		Metric
Input type		Gear motor
Input speed	[rpm]	1400
Output speed	[rpm]	0.5
Ratio (i=)		2800
Frequency	[Hz]	50
Input options		IEC
Requested input power	[kW]	0.25
Service factor		0.9
Rated Power P1	[kW]	0.23

Output data

Gear unit	M RT/RT 50/110 B3 21 2800 71 B14 AC 42 MT 0.25 kW 71 A4 B14 X3
------------------	---

Type		RT/RT - Worm speed reducers
Input type		M
Size		50/110
Ratio (i=)		2800
Gearbox ratio		40.00
Pre-stage ratio		70.00
Input flange		B14
Input speed	[rpm]	1400
Output speed	[rpm]	0.5
Rated output torque	[Nm]	1289.25
Service Factor		0.9
Efficiency		0.27

Gear unit configuration

Output shaft		Hollow output shaft
Fixing		Universal
Version		B3
Attachment position		21

Output radial and axial loads

Ball bearings output radial load	[N]	9800
Taper bearings output radial load	[N]	11100
Ball bearings output axial load	[N]	1960
Taper bearings output axial load	[N]	2220

Accessories

Hollow output shaft		AC 42
---------------------	--	-------

Electric motor

Size		71 A4
Poles		4
Power	[kW]	0.25

Electric motor configuration

Motor flange		B14
Terminal box position		X3

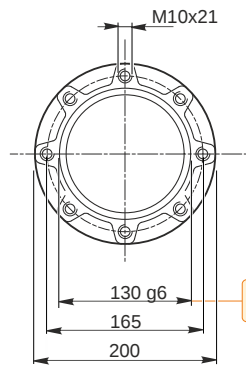
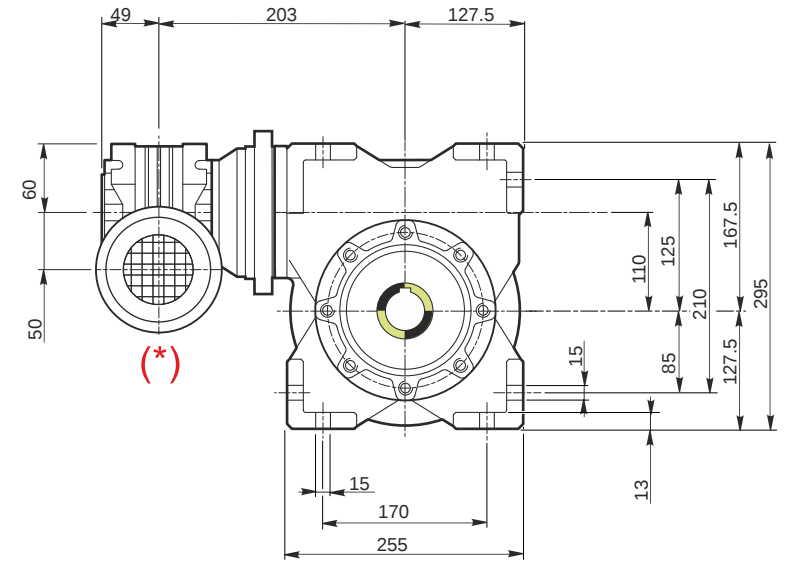
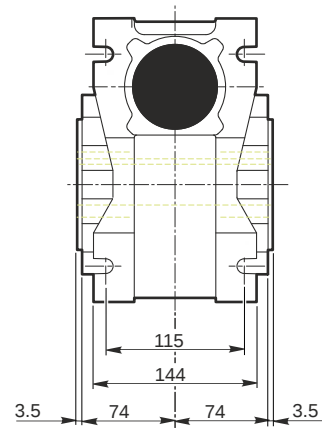
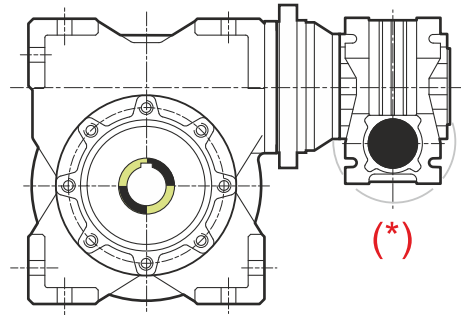

129.986
129.961

Hollow output shaft

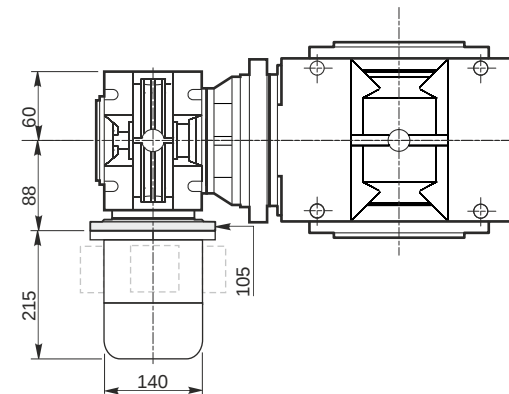
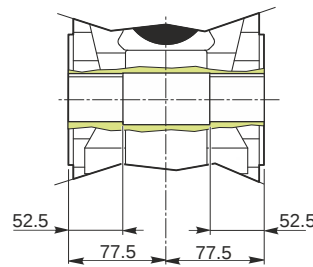
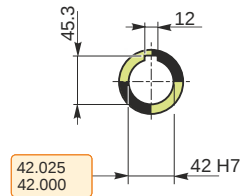

Mounting positions

B3

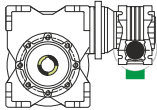

B6

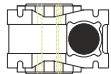

B7

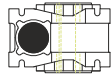

B8

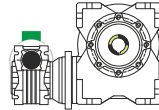

V5

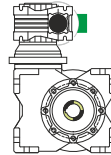

V6

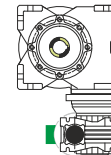

Terminal box position

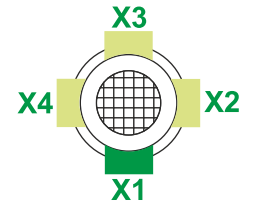

0.13

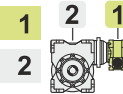

Oil quantity [litres]

1.5

Lubricant type: Long life synthetic oil ISO VG320

Attachment position

20
(std)

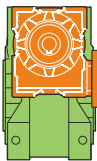
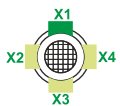

26

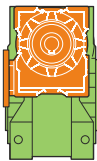
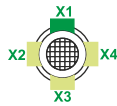

21

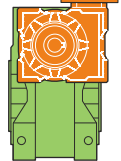
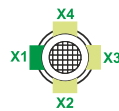

25

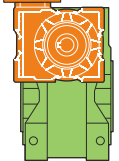
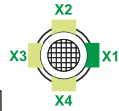

22

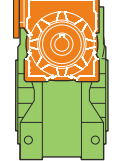
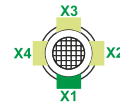

24

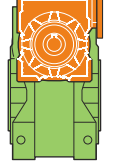
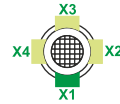

23

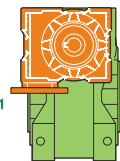
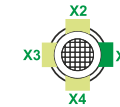

27

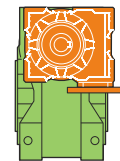
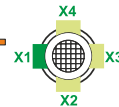

Direction of rotation

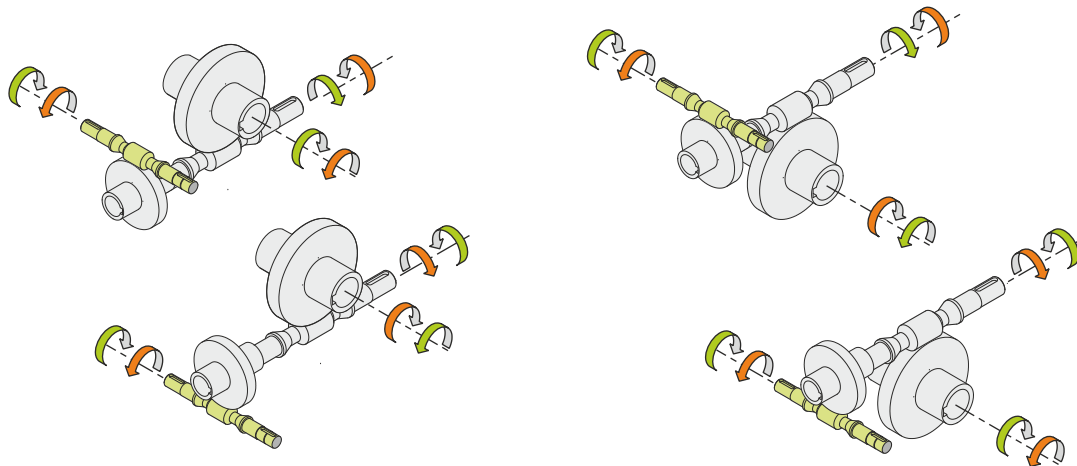

Weight

Gear unit [kg]	45
Electric motor [kg]	6.2

Gearing data



Axial module	4.4
Number of starts	1
Lead angle	5° 42'
Pressure angle	20°

Backdriving

- Static self-locking
- No back-driving
- No dynamic back-driving

M RT/RT 50/110 B3 21 2800 71 B14 AC 42 MT 0.25 kW 71 A4 B14 X3