

### Input data

|                       |       |            |   |
|-----------------------|-------|------------|---|
| System of measurement |       | Metric     |   |
| Input type            |       | Gear motor |   |
| Input speed           | [rpm] | 1400       |   |
| Output speed          | [rpm] | 1.25       |   |
| Ratio (i=)            |       | 1120       |   |
| Frequency             | [Hz]  | 50         |   |
| Input options         |       | IEC        |   |
| Requested input power | [kW]  | 0.06       |   |
| Service factor        |       | 0.6        | <b>Warning! The torque generated by the selected motor is above the gearbox rated output torque; please refer to the gearbox rated output torque.</b> |
| Rated Power P1        | [kW]  | 0.03       |   |

### Output data

|                  |   |  |  |
|------------------|---|--|--|
| <b>Gear unit</b> | <b>M RS/RS 28/40 S (bolted) 11 1120 56 B14 AC 19 MT 0.06 kW 56 A4 B14 X3 B3</b> |  |  |
|------------------|---|--|--|

|                     |       |                             |
|---------------------|-------|-----------------------------|
| Type                |       | RS/RS - Worm speed reducers |
| Input type          |       | M                           |
| Size                |       | 28/40                       |
| Ratio (i=)          |       | 1120                        |
| Gearbox ratio       |       | 28.00                       |
| Pre-stage ratio     |       | 40.00                       |
| Input flange        |       | B14                         |
| Mounting position   |       | B3                          |
| Input speed         | [rpm] | 1400                        |
| Output speed        | [rpm] | 1.25                        |
| Rated output torque | [Nm]  | 80                          |
| Service Factor      |       | 0.6                         |
| Efficiency          |       | 0.31                        |

#### Gear unit configuration

|                     |  |                     |
|---------------------|--|---------------------|
| Output shaft        |  | Hollow output shaft |
| Fixing              |  | Feet                |
| Version             |  | S (bolted)          |
| Attachment position |  | 11                  |

#### Output radial and axial loads

|                                   |     |      |
|-----------------------------------|-----|------|
| Ball bearings output radial load  | [N] | 2300 |
| Taper bearings output radial load | [N] | 2600 |
| Ball bearings output axial load   | [N] | 460  |
| Taper bearings output axial load  | [N] | 520  |

#### Accessories

|                     |  |       |
|---------------------|--|-------|
| Hollow output shaft |  | AC 19 |
|---------------------|--|-------|

#### Electric motor

|       |      |       |
|-------|------|-------|
| Size  |      | 56 A4 |
| Poles |      | 4     |
| Power | [kW] | 0.06  |

#### Electric motor configuration

|                       |  |     |
|-----------------------|--|-----|
| Motor flange          |  | B14 |
| Terminal box position |  | X3  |

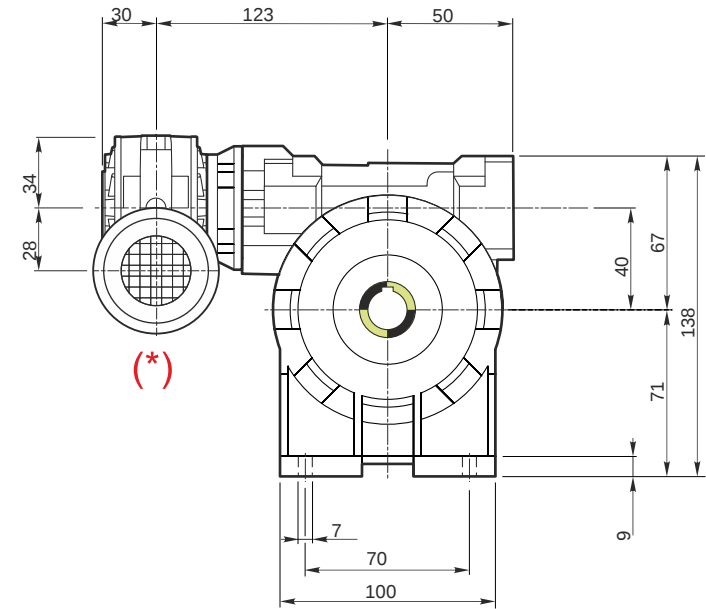
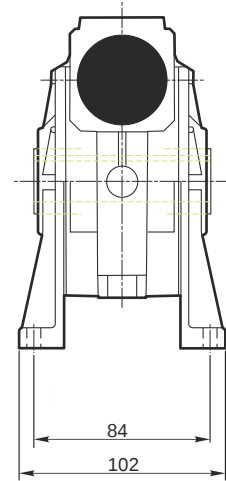
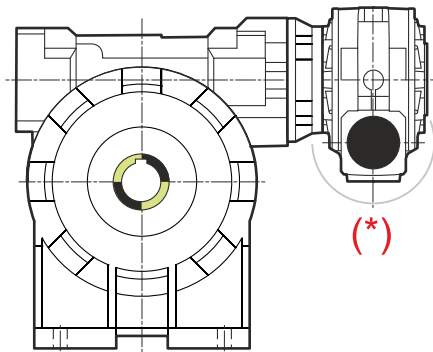

**Hollow output shaft**

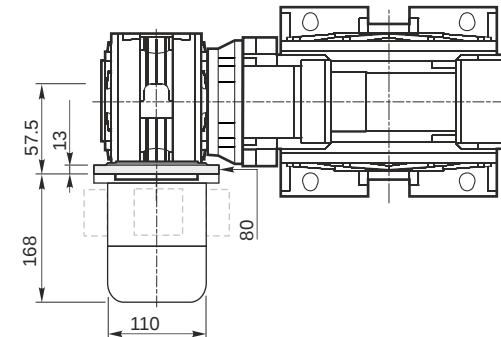
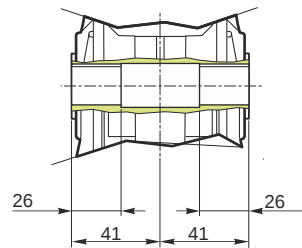
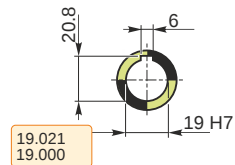

**M RS/RS 28/40 S (bolted) 11 1120 56 B14 AC 19 MT 0.06 kW 56 A4 B14 X3 B3**

**Mounting positions**

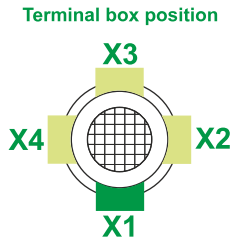
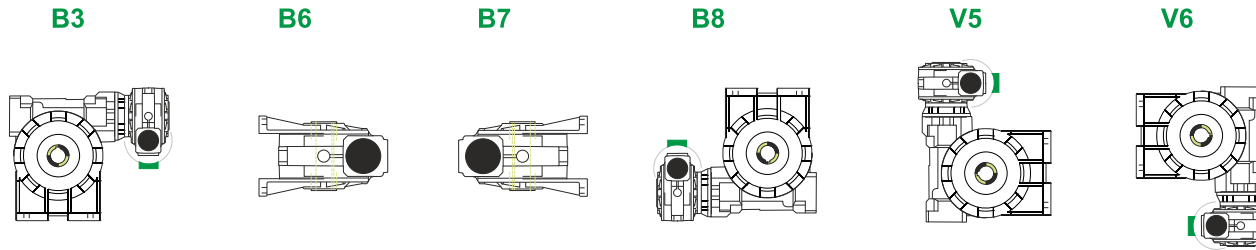

|      |   |
|------|---|
| 0.03 | 1 |
| 0.08 | 2 |

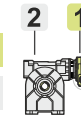

Oil quantity [litres]

Lubricant type: Long life synthetic oil ISO VG320

**Attachment position**

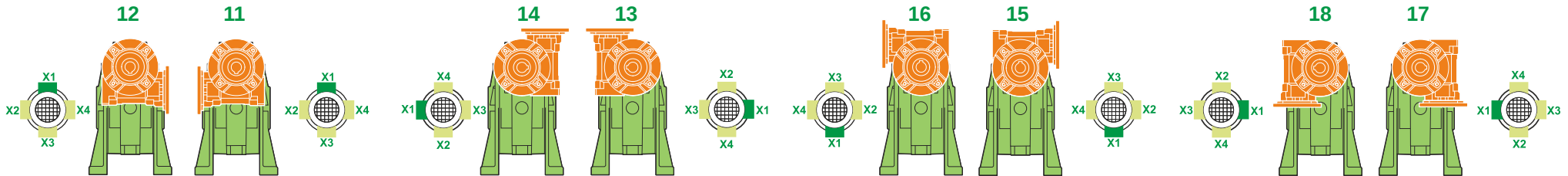

**Direction of rotation**

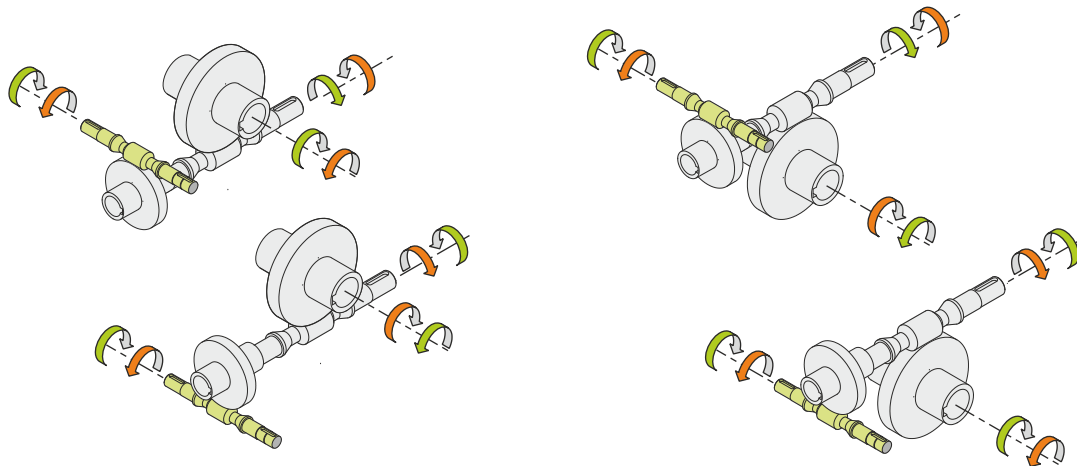

**Weight**

|                     |     |
|---------------------|-----|
| Gear unit [kg]      | 3.9 |
| Electric motor [kg] | 2.6 |

**Gearing data 2**



|                  |        |
|------------------|--------|
| Axial module     | 2.1    |
| Number of starts | 1      |
| Lead angle       | 1      |
| Pressure angle   | 50°39' |

**Backdriving**

- Static self-locking
- Slow back-driving in case of vibrations
- Low dynamic back-driving

**M RS/RS 28/40 S (bolted) 11 1120 56 B14 AC 19 MT 0.06 kW 56 A4 B14 X3 B3**