

Input data

System of measurement		Metric
Input type		Gear motor
Input speed	[rpm]	1400
Output speed	[rpm]	3.33
Ratio (i=)		420
Frequency	[Hz]	50
Input options		IEC
Requested input power	[kW]	0.75
Service factor		1.2
Rated Power P1	[kW]	0.87

Output data

Gear unit M RS/RS 50/110 S (bolted) 11 420 80 B14 AC 42 MT 0.75 kW 80 B4 B14 X3 B3

Type		RS/RS - Worm speed reducers
Input type		M
Size		50/110
Ratio (i=)		420
Gearbox ratio		28.00
Pre-stage ratio		15.00
Input flange		B14
Mounting position		B3
Input speed	[rpm]	1400
Output speed	[rpm]	3.33
Rated output torque	[Nm]	1031.4
Service Factor		1.2
Efficiency		0.48

Gear unit configuration

Output shaft		Hollow output shaft
Fixing		Feet
Version		S (bolted)
Attachment position		11

Output radial and axial loads

Ball bearings output radial load	[N]	9800
Taper bearings output radial load	[N]	11100
Ball bearings output axial load	[N]	1960
Taper bearings output axial load	[N]	2220

Accessories

Hollow output shaft		AC 42
---------------------	--	-------

Electric motor

Size		80 B4
Poles		4
Power	[kW]	0.75

Electric motor configuration

Motor flange		B14
Terminal box position		X3

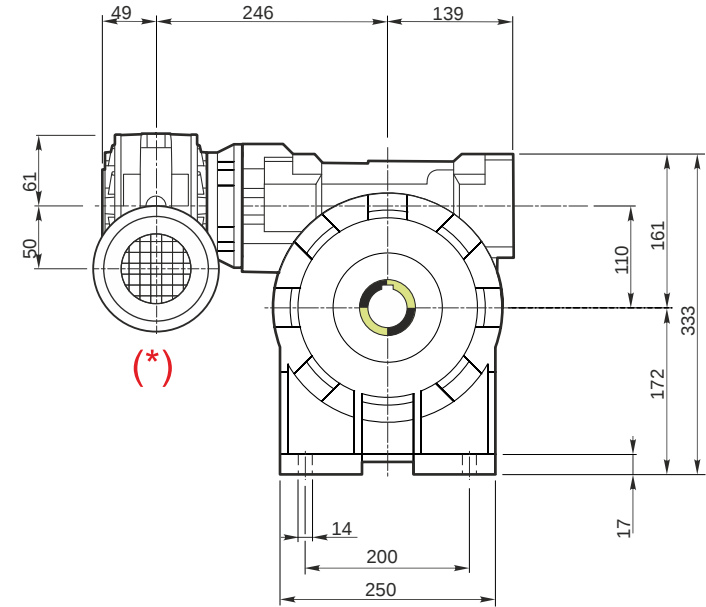
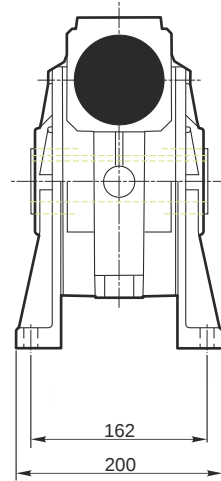
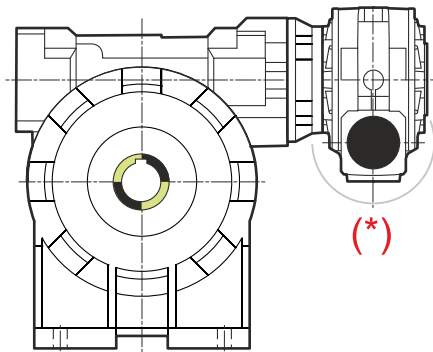

Hollow output shaft

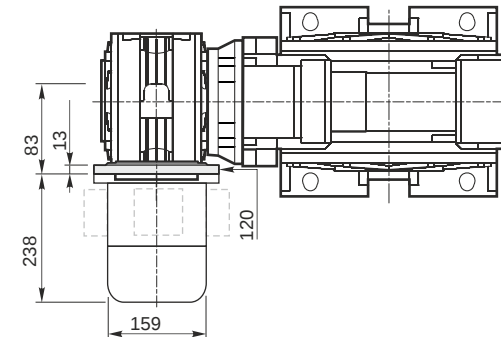
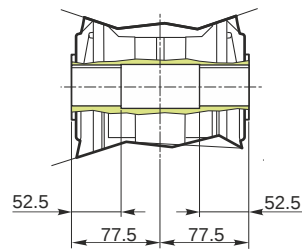
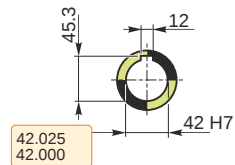

M RS/RS 50/110 S (bolted) 11 420 80 B14 AC 42 MT 0.75 kW 80 B4 B14 X3 B3

Mounting positions

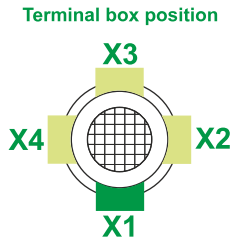
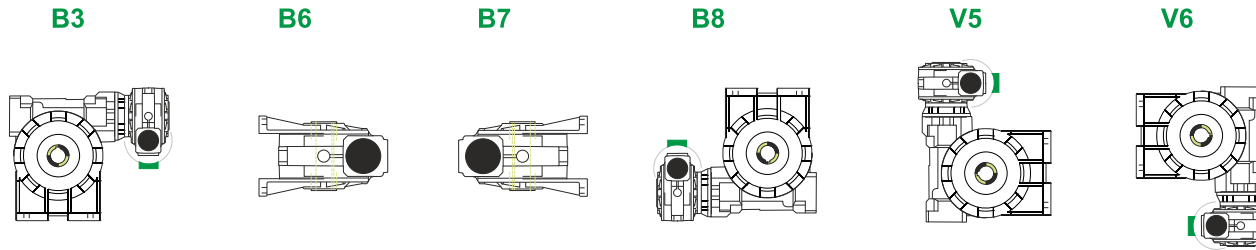

0.13	1
1.5	2



Lubricant type: Long life synthetic oil ISO VG320

Attachment position

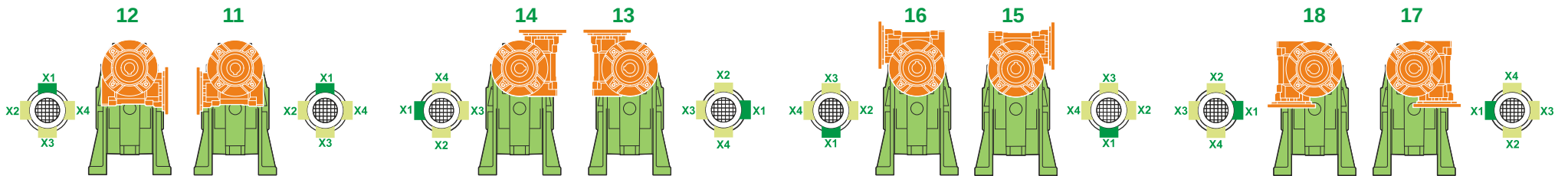

Direction of rotation

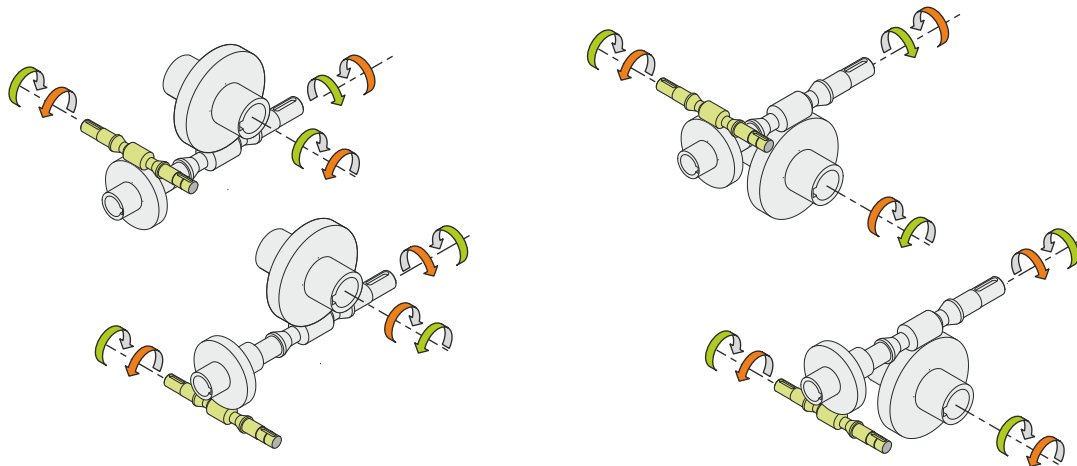

Weight

Gear unit [kg]	45
Electric motor [kg]	9.8

Gearing data 2

	Axial module	6.1
	Number of starts	1
	Lead angle	1
	Pressure angle	20°04'

Backdriving

- Static self-locking
- Slow back-driving in case of vibrations
- Low dynamic back-driving

M RS/RS 50/110 S (bolted) 11 420 80 B14 AC 42 MT 0.75 kW 80 B4 B14 X3 B3