

Input data

| | | |
|-----------------------|-------|------------|
| System of measurement | | Metric |
| Input type | | Gear motor |
| Input speed | [rpm] | 1400 |
| Output speed | [rpm] | 0.89 |
| Ratio (i=) | | 1568 |
| Frequency | [Hz] | 50 |
| Input options | | IEC |
| Requested input power | [kW] | 0.37 |
| Service factor | | 1 |
| Rated Power P1 | [kW] | 0.38 |

Output data

| | |
|------------------|----------------------------------------------------------------------------------|
| Gear unit | M RS/RS 50/110 S (bolted) 11 1568 71 B14 AC 42 MT 0.37 kW 71 B4 B14 X3 B3 |
|------------------|----------------------------------------------------------------------------------|

| | | |
|---------------------|-------|-----------------------------|
| Type | | RS/RS - Worm speed reducers |
| Input type | | M |
| Size | | 50/110 |
| Ratio (i=) | | 1568 |
| Gearbox ratio | | 28.00 |
| Pre-stage ratio | | 56.00 |
| Input flange | | B14 |
| Mounting position | | B3 |
| Input speed | [rpm] | 1400 |
| Output speed | [rpm] | 0.89 |
| Rated output torque | [Nm] | 1305.98 |
| Service Factor | | 1 |
| Efficiency | | 0.33 |

Gear unit configuration

| | | |
|---------------------|--|---------------------|
| Output shaft | | Hollow output shaft |
| Fixing | | Feet |
| Version | | S (bolted) |
| Attachment position | | 11 |

Output radial and axial loads

| | | |
|-----------------------------------|-----|-------|
| Ball bearings output radial load | [N] | 9800 |
| Taper bearings output radial load | [N] | 11100 |
| Ball bearings output axial load | [N] | 1960 |
| Taper bearings output axial load | [N] | 2220 |

Accessories

| | | |
|---------------------|--|-------|
| Hollow output shaft | | AC 42 |
|---------------------|--|-------|

Electric motor

| | | |
|-------|------|-------|
| Size | | 71 B4 |
| Poles | | 4 |
| Power | [kW] | 0.37 |

Electric motor configuration

| | | |
|-----------------------|--|-----|
| Motor flange | | B14 |
| Terminal box position | | X3 |

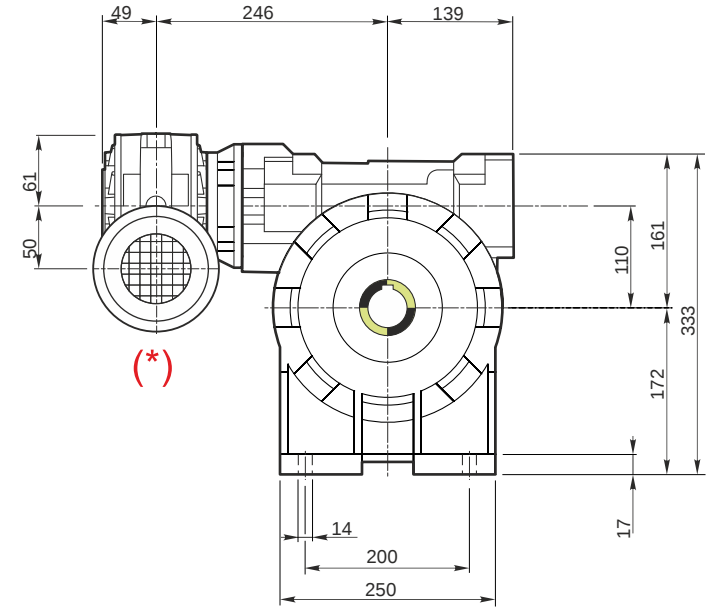
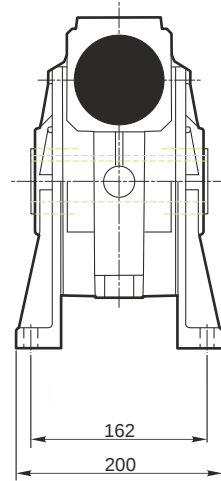
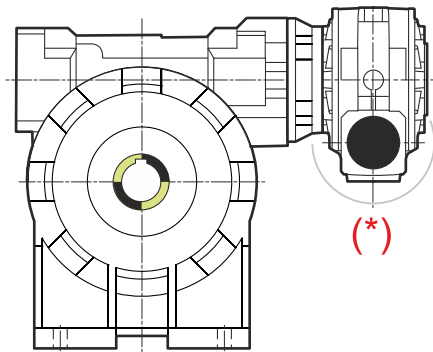

Hollow output shaft

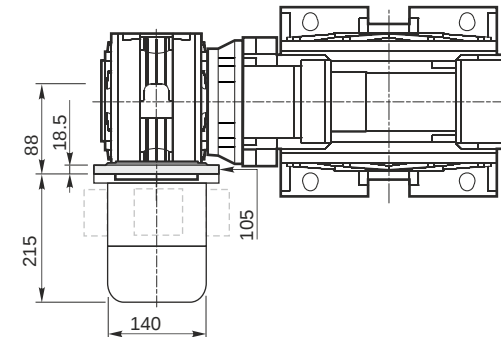
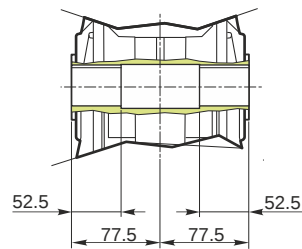
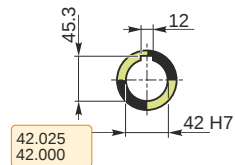

M RS/RS 50/110 S (bolted) 11 1568 71 B14 AC 42 MT 0.37 kW 71 B4 B14 X3 B3

Mounting positions

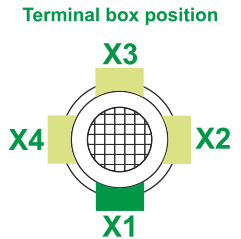
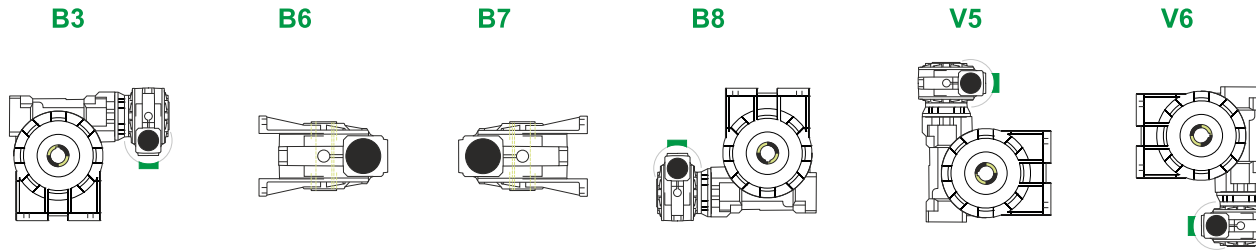

| | |
|------|---|
| 0.13 | 1 |
| 1.5 | 2 |



Lubricant type: Long life synthetic oil ISO VG320

Attachment position

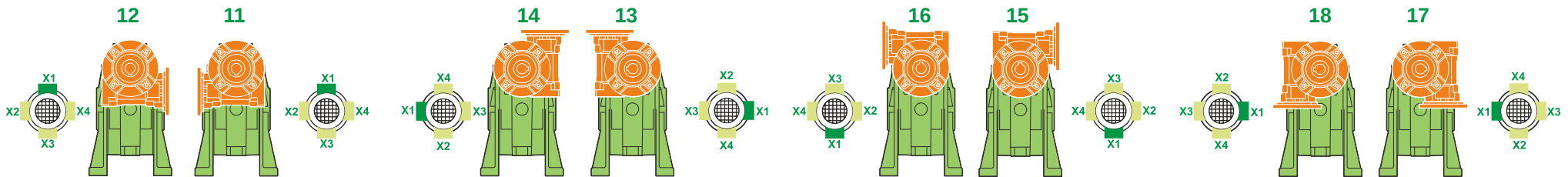

Direction of rotation

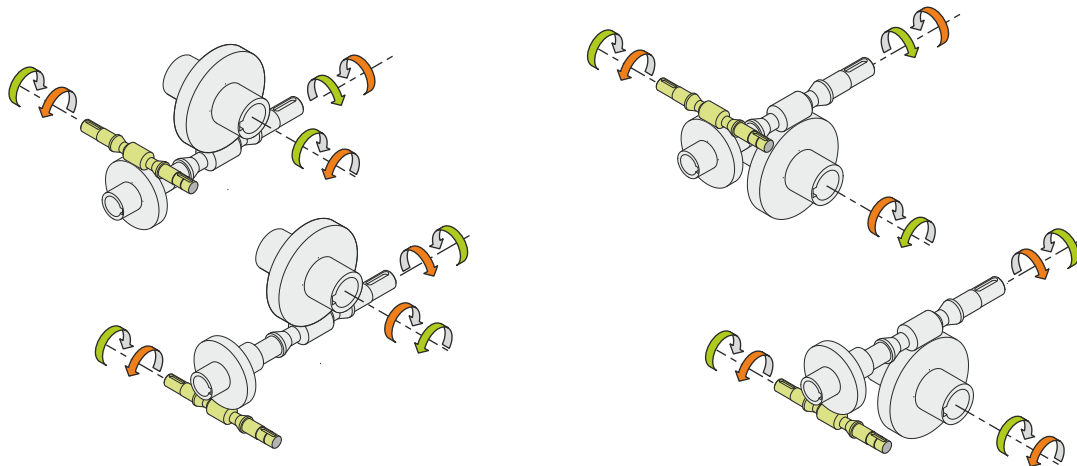

Weight

| | |
|---------------------|-----|
| Gear unit [kg] | 45 |
| Electric motor [kg] | 6.2 |

Gearing data 2

| | | |
|---|------------------|--------|
| 2 | Axial module | 6.1 |
| | Number of starts | 1 |
| | Lead angle | 1 |
| | Pressure angle | 20°04' |

Backdriving

- Static self-locking
- Slow back-driving in case of vibrations
- Low dynamic back-driving

M RS/RS 50/110 S (bolted) 11 1568 71 B14 AC 42 MT 0.37 kW 71 B4 B14 X3 B3