

### Input data

System of measurement		Metric	
Input type		Gear motor	
Input speed	[rpm]	1400	
Output speed	[rpm]	0.14	
Ratio (i=)		10000	
Frequency	[Hz]	50	
Input options		IEC	
Requested input power	[kW]	0.25	
Service factor		0.5	<b>Warning! The torque generated by the selected motor is above the gearbox rated output torque; please refer to the gearbox rated output torque.</b>
Rated Power P1	[kW]	0.13	

### Output data

**Gear unit** **M RS/RS 70/150 S (integral) 11 10000 71 B5 AC 55 MT 0.25 kW 71 A4 B5 X3 B3**

Type		RS/RS - Worm speed reducers
Input type		M
Size		70/150
Ratio (i=)		10000
Gearbox ratio		100.00
Pre-stage ratio		100.00
Input flange		B5
Mounting position		B3
Input speed	[rpm]	1400
Output speed	[rpm]	0.14
Rated output torque	[Nm]	1995
Service Factor		0.5
Efficiency		0.22

#### Gear unit configuration

Output shaft		Hollow output shaft
Fixing		Feet
Version		S (integral)
Attachment position		11

#### Output radial and axial loads

Ball bearings output radial load	[N]	15000
Taper bearings output radial load	[N]	19500
Ball bearings output axial load	[N]	3000
Taper bearings output axial load	[N]	3900

#### Accessories

Hollow output shaft		AC 55
---------------------	--	-------

#### Electric motor

Size		71 A4
Poles		4
Power	[kW]	0.25

#### Electric motor configuration

Motor flange		B5
Terminal box position		X3

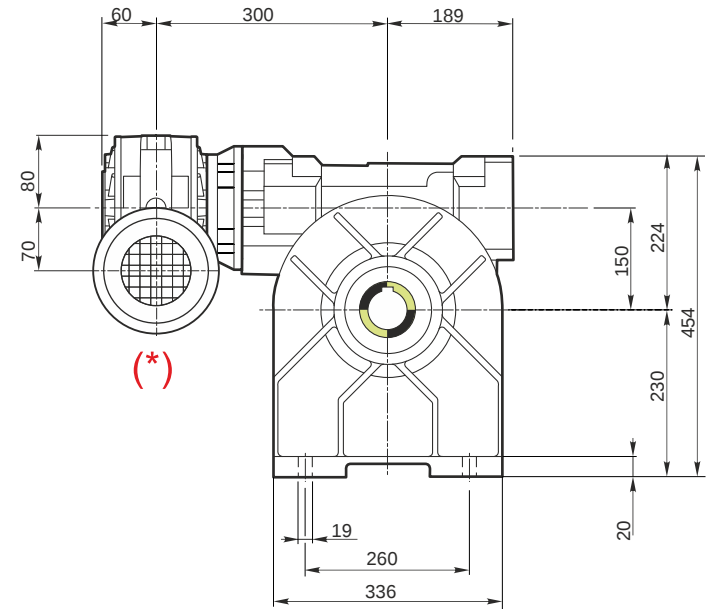
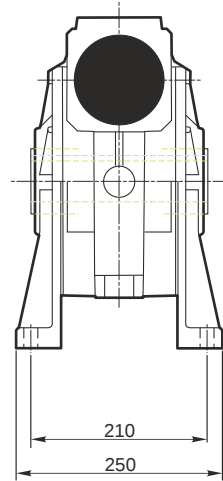
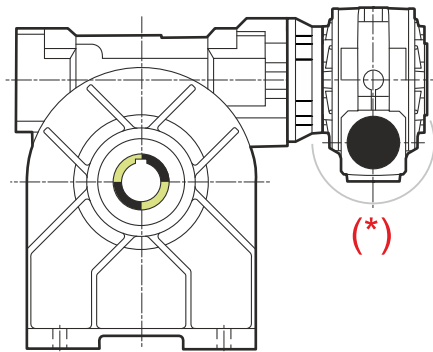

**Hollow output shaft**

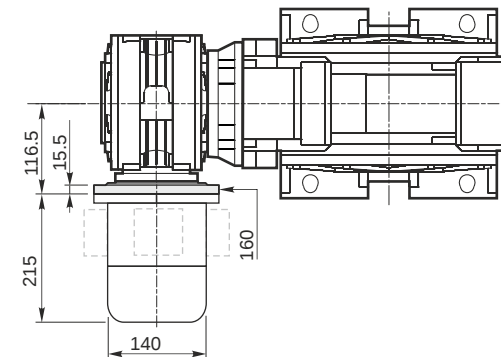
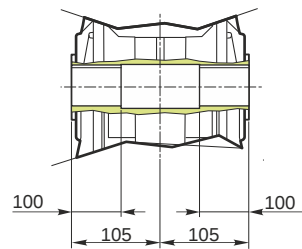
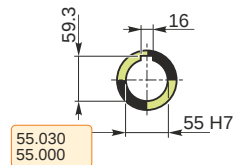

**M RS/RS 70/150 S (integral) 11 10000 71 B5 AC 55 MT 0.25 kW 71 A4 B5 X3 B3**

**Mounting positions**

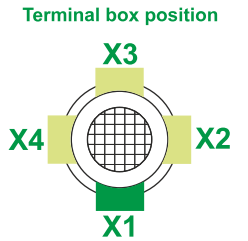
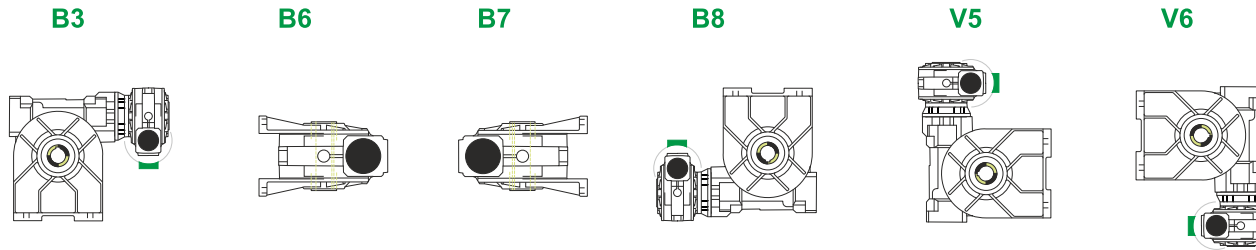

0.35	1
4.4	2



Lubricant type: Long life synthetic oil ISO VG320

**Attachment position**

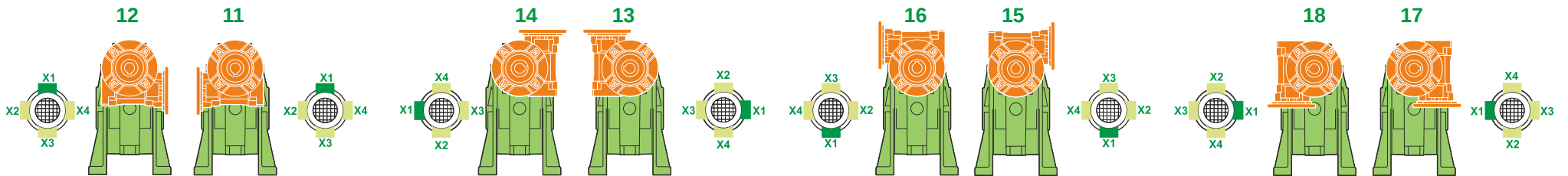

**Direction of rotation**

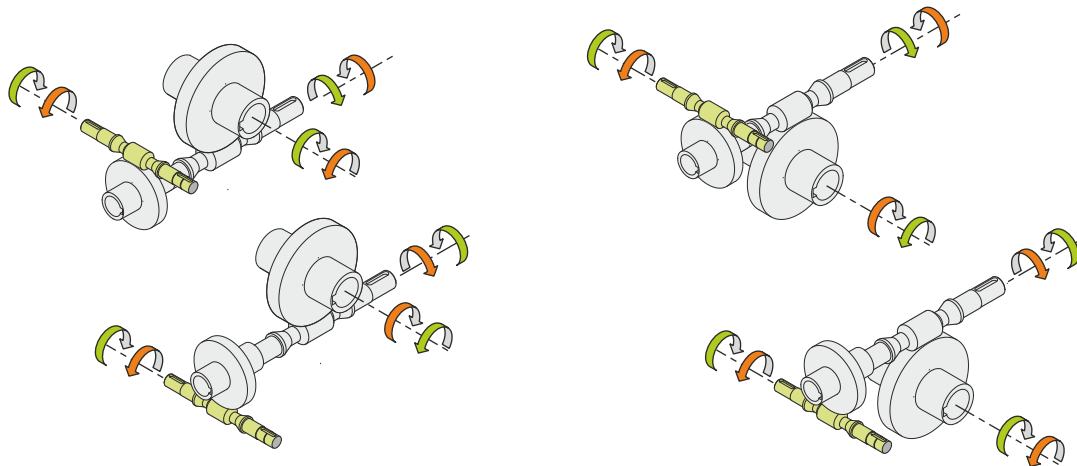

**Weight**

Gear unit [kg]	90
Electric motor [kg]	6.2

**Gearing data 2**

	Axial module	2.6
	Number of starts	1
	Lead angle	30° 43'
	Pressure angle	30° 43'

**Backdriving**

- Static self-locking
- No back-driving
- No dynamic back-driving

**M RS/RS 70/150 S (integral) 11 10000 71 B5 AC 55 MT 0.25 kW 71 A4 B5 X3 B3**