

Input data

| | | |
|-----------------------|-------|------------|
| System of measurement | | Metric |
| Input type | | Gear motor |
| Input speed | [rpm] | 1400 |
| Output speed | [rpm] | 7.81 |
| Ratio (i=) | | 179.2 |
| Frequency | [Hz] | 50 |
| Input options | | IEC |
| Requested input power | [kW] | 0.37 |
| Service factor | | 0.9 |
| Rated Power P1 | [kW] | 0.34 |

Output data

| | |
|------------------|--|
| Gear unit | M TA 71/60 B3 10 179.2 71 B14 AC 25 MT 0.37 kW 71 B4 B14 X3 |
|------------------|--|

| | | |
|---------------------|---------------------|--------------------------|
| Type | | TA - Worm speed reducers |
| Input type | | M |
| Size | | 71/60 |
| Ratio (i=) | | 179.2 |
| Gearbox ratio | | 28.00 |
| Pre-stage ratio | | 6.40 |
| Input flange | | B14 |
| Input speed | [rpm] | 1400 |
| Output speed | [rpm] | 7.81 |
| Rated output torque | [Nm] | 257.8 |
| Service Factor | | 0.9 |
| Efficiency | | 0.57 |
| Inertia moment | [kgm ²] | 0.000047 |

Gear unit configuration

| | | |
|---------------------|--|---------------------|
| Output shaft | | Hollow output shaft |
| Fixing | | Universal |
| Version | | B3 |
| Attachment position | | 10 |

Output radial and axial loads

| | | |
|-----------------------------------|-----|------|
| Ball bearings output radial load | [N] | 5600 |
| Taper bearings output radial load | [N] | 6600 |
| Ball bearings output axial load | [N] | 1120 |
| Taper bearings output axial load | [N] | 1320 |

Accessories

| | | |
|---------------------|--|-------|
| Hollow output shaft | | AC 25 |
|---------------------|--|-------|

Electric motor

| | | |
|-------|------|-------|
| Size | | 71 B4 |
| Poles | | 4 |
| Power | [kW] | 0.37 |

Electric motor configuration

| | | |
|-----------------------|--|-----|
| Motor flange | | B14 |
| Terminal box position | | X3 |

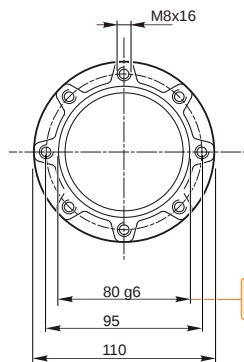
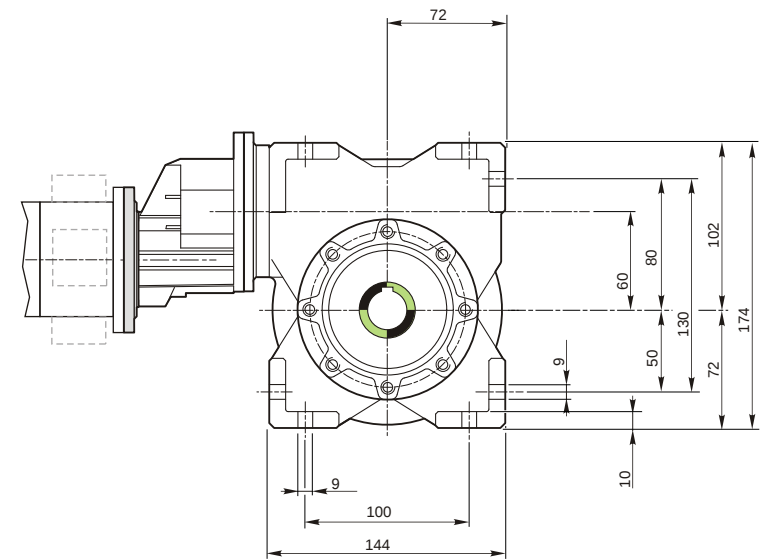
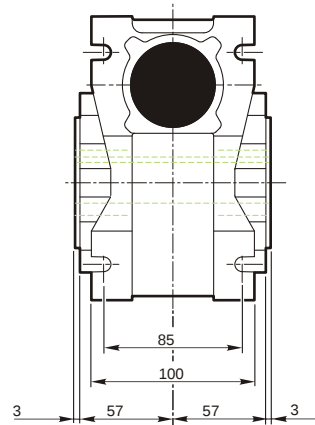
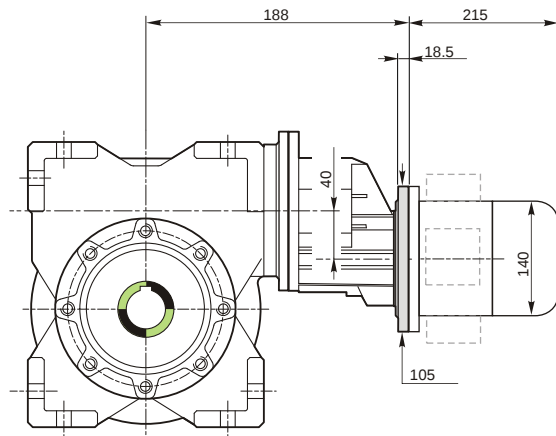

79.99
79.971

Hollow output shaft

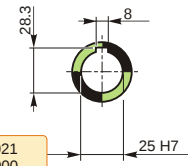

25.021
25.000

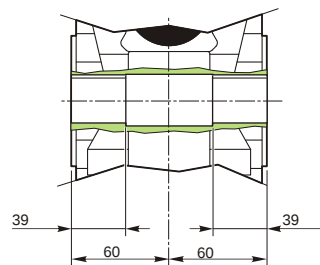

Attachment position

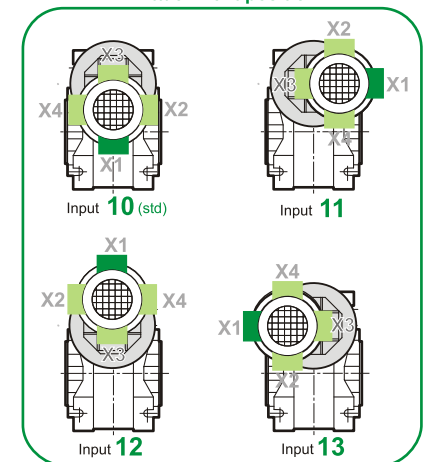

M TA 71/60 B3 10 179.2 71 B14 AC 25 MT 0.37 kW 71 B4 B14 X3

Mounting positions

B3

B6

B7

B8

V5

V6

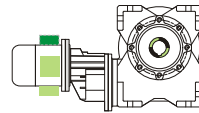
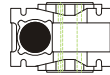
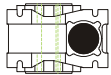
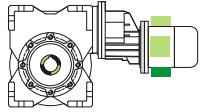

Terminal box position

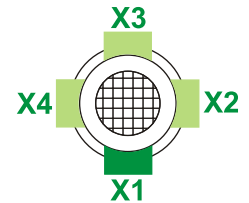

0.05

1



0.23

2



← Oil quantity [litres]

Lubricant type: Long life synthetic oil ISO VG320

Direction of rotation

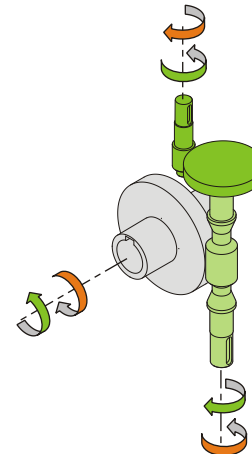
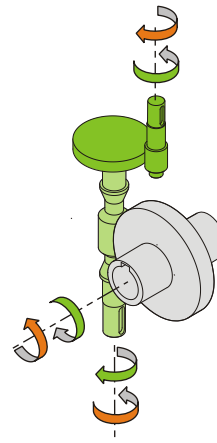
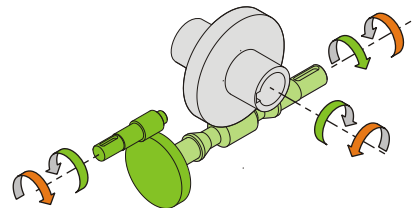
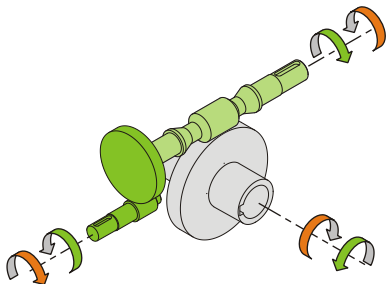

Weight

| | |
|---------------------|-----|
| Gear unit [kg] | 9.3 |
| Electric motor [kg] | 6.2 |

Gearing data

| | |
|------------------|--------|
| Axial module | 3.3 |
| Number of starts | 1 |
| Lead angle | 6° 49' |
| Pressure angle | 20° |

Backdriving

Static self-locking
Slow back-driving in case of vibrations
Low dynamic back-driving

M TA 71/60 B3 10 179.2 71 B14 AC 25 MT 0.37 kW 71 B4 B14 X3