

### Input data

|                       |       |            |
|-----------------------|-------|------------|
| System of measurement |       | Metric     |
| Input type            |       | Gear motor |
| Input speed           | [rpm] | 1400       |
| Output speed          | [rpm] | 5.47       |
| Ratio (i=)            |       | 256        |
| Frequency             | [Hz]  | 50         |
| Input options         |       | IEC        |
| Requested input power | [kW]  | 0.37       |
| Service factor        |       | 0.8        |
| Rated Power P1        | [kW]  | 0.31       |

### Output data

**Gear unit** **M TA 71/70 B3 10 256 71 B14 AC 28 MT 0.37 kW 71 B4 B14 X3**

|                     |                     |                          |
|---------------------|---------------------|--------------------------|
| Type                |                     | TA - Worm speed reducers |
| Input type          |                     | M                        |
| Size                |                     | 71/70                    |
| Ratio (i=)          |                     | 256                      |
| Gearbox ratio       |                     | 40.00                    |
| Pre-stage ratio     |                     | 6.40                     |
| Input flange        |                     | B14                      |
| Input speed         | [rpm]               | 1400                     |
| Output speed        | [rpm]               | 5.47                     |
| Rated output torque | [Nm]                | 348.91                   |
| Service Factor      |                     | 0.8                      |
| Efficiency          |                     | 0.54                     |
| Inertia moment      | [kgm <sup>2</sup> ] | 0.000051                 |

#### Gear unit configuration

|                     |  |                     |
|---------------------|--|---------------------|
| Output shaft        |  | Hollow output shaft |
| Fixing              |  | Universal           |
| Version             |  | B3                  |
| Attachment position |  | 10                  |

#### Output radial and axial loads

|                                   |     |      |
|-----------------------------------|-----|------|
| Ball bearings output radial load  | [N] | 6700 |
| Taper bearings output radial load | [N] | 7900 |
| Ball bearings output axial load   | [N] | 1340 |
| Taper bearings output axial load  | [N] | 1580 |

#### Accessories

|                     |  |       |
|---------------------|--|-------|
| Hollow output shaft |  | AC 28 |
|---------------------|--|-------|

#### Electric motor

|       |      |       |
|-------|------|-------|
| Size  |      | 71 B4 |
| Poles |      | 4     |
| Power | [kW] | 0.37  |

#### Electric motor configuration

|                       |  |     |
|-----------------------|--|-----|
| Motor flange          |  | B14 |
| Terminal box position |  | X3  |

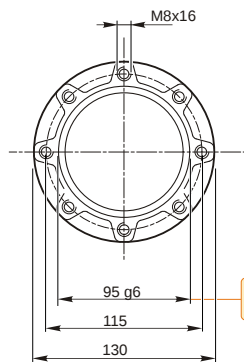
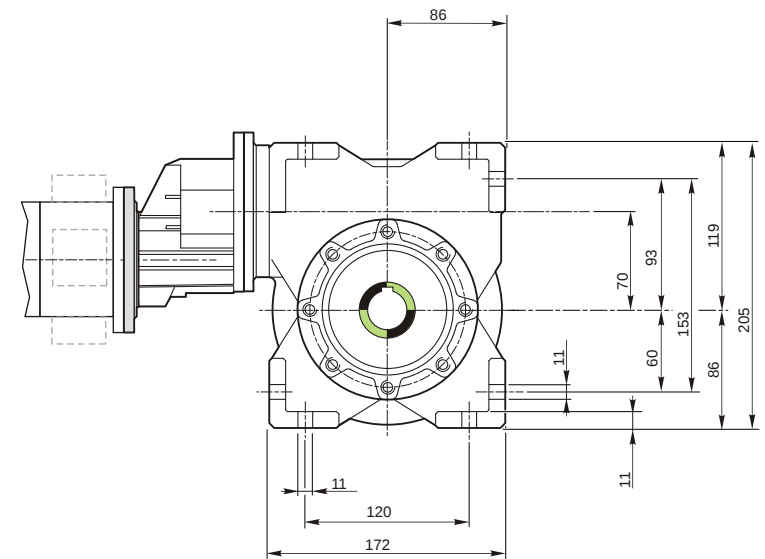
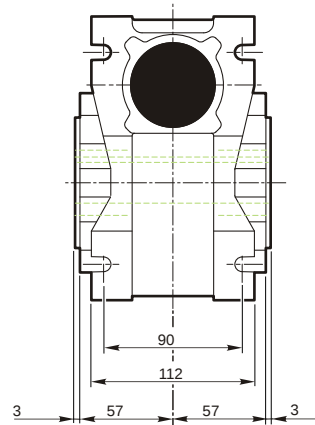
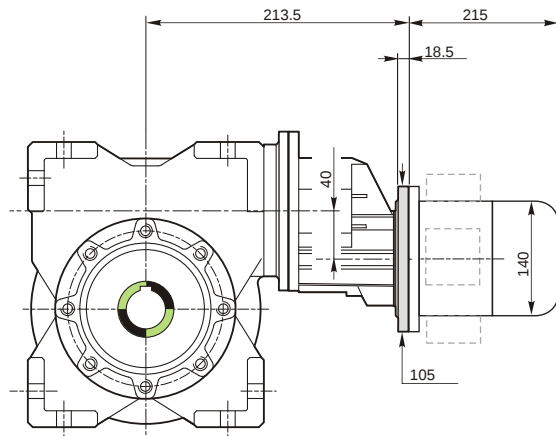

94.988  
94.966

Hollow output shaft

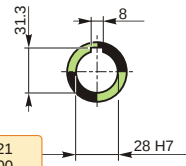

28.021  
28.000

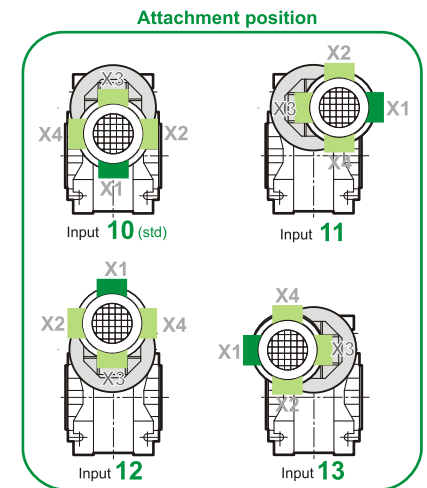
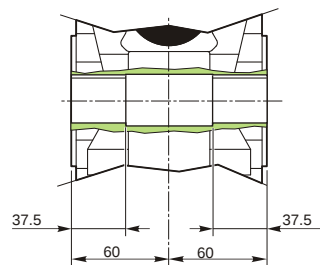

**Mounting positions**

**B3**

**B6**

**B7**

**B8**

**V5**

**V6**

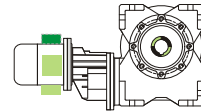
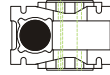
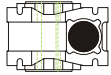
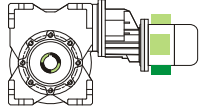

Terminal box position

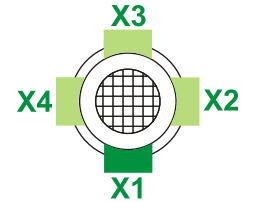

0.05

1



0.35

2

← Oil quantity [litres]

Lubricant type: Long life synthetic oil ISO VG320

**Direction of rotation**

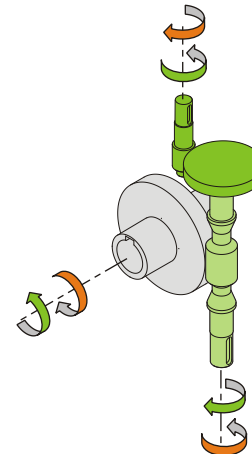
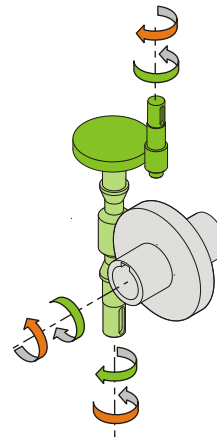
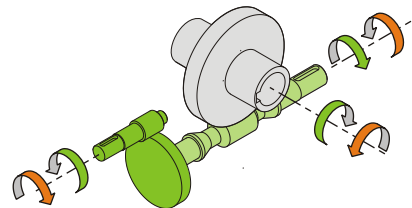
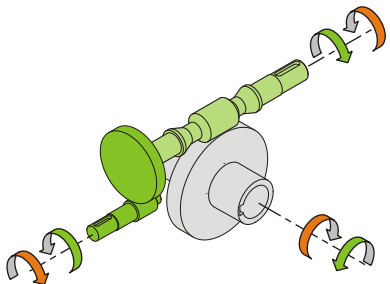

**Weight**

|                     |      |
|---------------------|------|
| Gear unit [kg]      | 11.8 |
| Electric motor [kg] | 6.2  |

**Gearing data**

|                  |        |
|------------------|--------|
| Axial module     | 2.8    |
| Number of starts | 1      |
| Lead angle       | 5° 42' |
| Pressure angle   | 20°    |

**Backdriving**

Static self-locking  
Slow back-driving in case of vibrations  
Low dynamic back-driving

**M TA 71/70 B3 10 256 71 B14 AC 28 MT 0.37 kW 71 B4 B14 X3**