

Input data

System of measurement		Metric
Input type		Gear motor
Input speed	[rpm]	1400
Output speed	[rpm]	21.88
Ratio (i=)		64
Frequency	[Hz]	50
Input options		IEC
Requested input power	[kW]	0.75
Service factor		1
Rated Power P1	[kW]	0.72

Output data

Gear unit **M TA 80/60 B3 10 64 80 B14 AC 25 MT 0.75 kW 80 B4 B14 X3**

Type		TA - Worm speed reducers
Input type		M
Size		80/60
Ratio (i=)		64
Gearbox ratio		10.00
Pre-stage ratio		6.40
Input flange		B14
Input speed	[rpm]	1400
Output speed	[rpm]	21.88
Rated output torque	[Nm]	245.57
Service Factor		1
Efficiency		0.75
Inertia moment	[kgm ²]	0.000259

Gear unit configuration

Output shaft		Hollow output shaft
Fixing		Universal
Version		B3
Attachment position		10

Output radial and axial loads

Ball bearings output radial load	[N]	4800
Taper bearings output radial load	[N]	6400
Ball bearings output axial load	[N]	960
Taper bearings output axial load	[N]	1280

Accessories

Hollow output shaft		AC 25
---------------------	--	-------

Electric motor

Size		80 B4
Poles		4
Power	[kW]	0.75

Electric motor configuration

Motor flange		B14
Terminal box position		X3

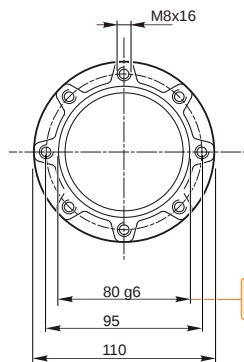
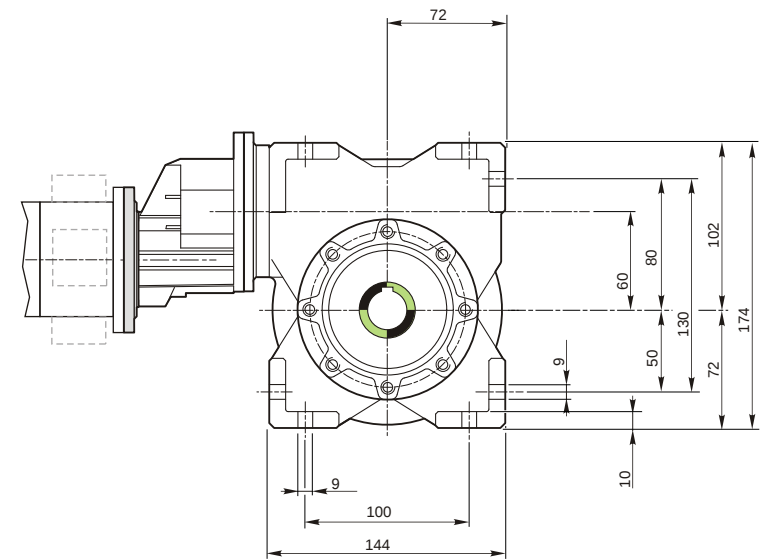
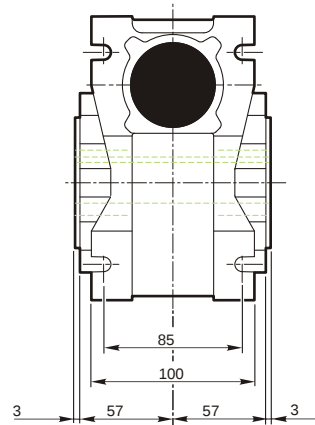
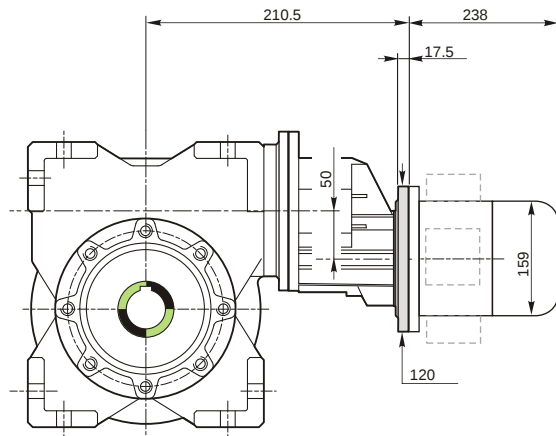

79.99
79.971

Hollow output shaft

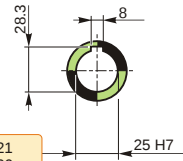

25.021
25.000

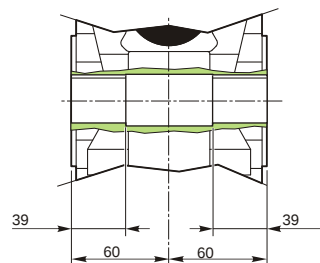

Attachment position

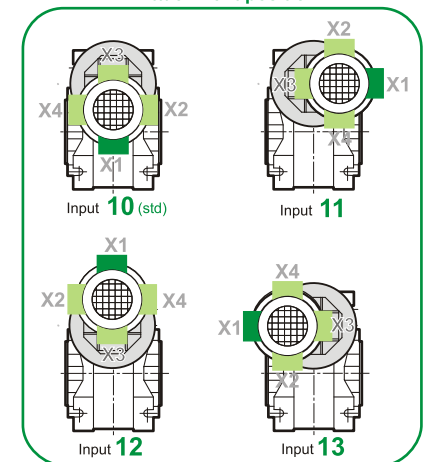

Mounting positions

B3

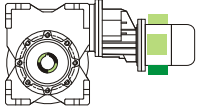

B6

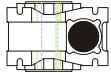

B7

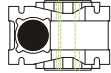

B8

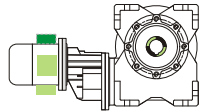

V5

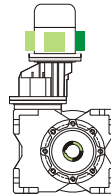

V6



Terminal box position

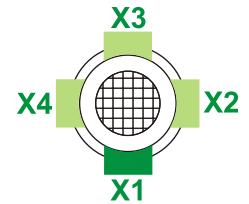

0.1	1	2	1
0.23	2	1	1

← Oil quantity [litres]

Lubricant type: Long life synthetic oil ISO VG320

Direction of rotation

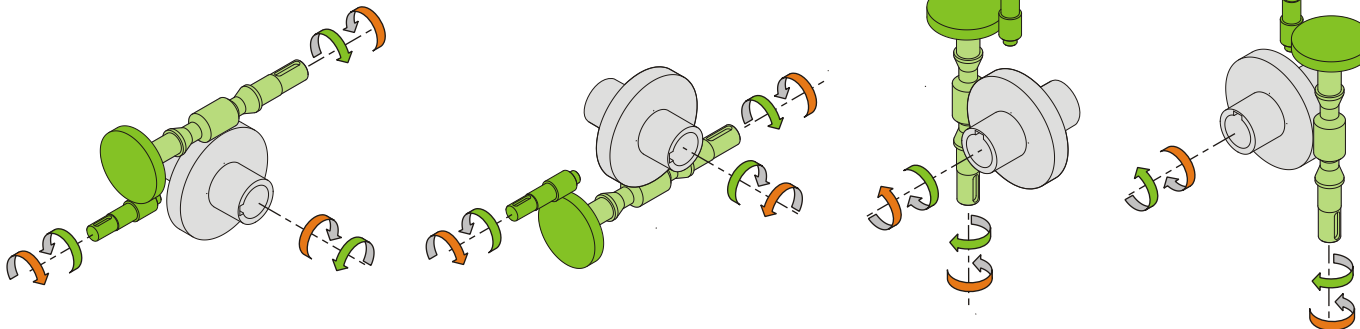

Weight

Gear unit [kg]	10.5
Electric motor [kg]	9.8

Gearing data

Axial module	3.1
Number of starts	3
Lead angle	19 °0'
Pressure angle	20°

Backdriving

- Static back-driving
- Quick back-driving
- Dynamic back-driving

M TA 80/60 B3 10 64 80 B14 AC 25 MT 0.75 kW 80 B4 B14 X3