

### Input data

System of measurement		Metric
Input type		Gear motor
Input speed	[rpm]	1400
Output speed	[rpm]	10.94
Ratio (i=)		128
Frequency	[Hz]	50
Input options		IEC
Requested input power	[kW]	0.55
Service factor		0.9
Rated Power P1	[kW]	0.49

### Output data

**Gear unit** **M TA 80/70 B3 10 128 80 B5 AC 28 MT 0.55 kW 80 A4 B5 X3**

Type		TA - Worm speed reducers
Input type		M
Size		80/70
Ratio (i=)		128
Gearbox ratio		20.00
Pre-stage ratio		6.40
Input flange		B5
Input speed	[rpm]	1400
Output speed	[rpm]	10.94
Rated output torque	[Nm]	326.56
Service Factor		0.9
Efficiency		0.68
Inertia moment	[kgm <sup>2</sup> ]	0.000262

#### Gear unit configuration

Output shaft		Hollow output shaft
Fixing		Universal
Version		B3
Attachment position		10

#### Output radial and axial loads

Ball bearings output radial load	[N]	6700
Taper bearings output radial load	[N]	7900
Ball bearings output axial load	[N]	1340
Taper bearings output axial load	[N]	1580

#### Accessories

Hollow output shaft		AC 28
---------------------	--	-------

#### Electric motor

Size		80 A4
Poles		4
Power	[kW]	0.55

#### Electric motor configuration

Motor flange		B5
Terminal box position		X3

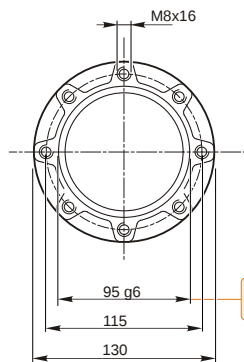
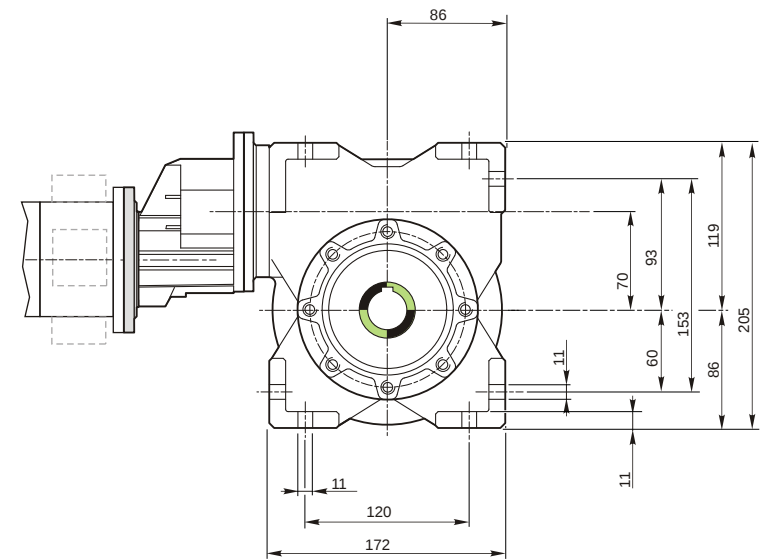
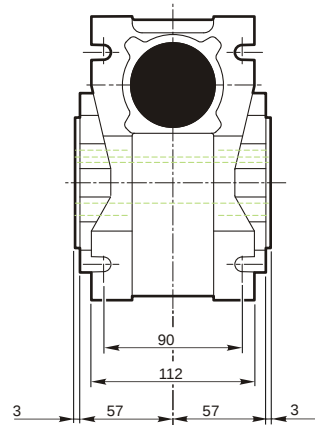
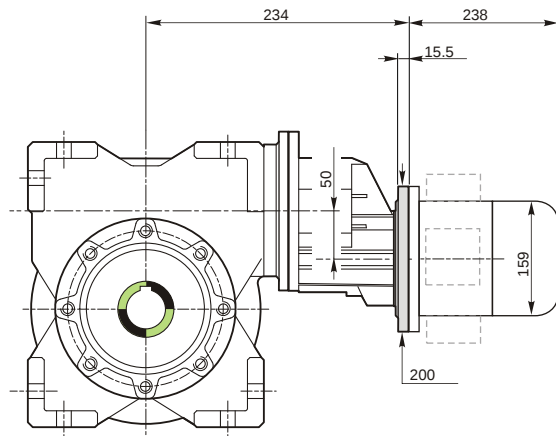

94.988  
94.966

Hollow output shaft

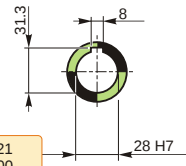

28.021  
28.000

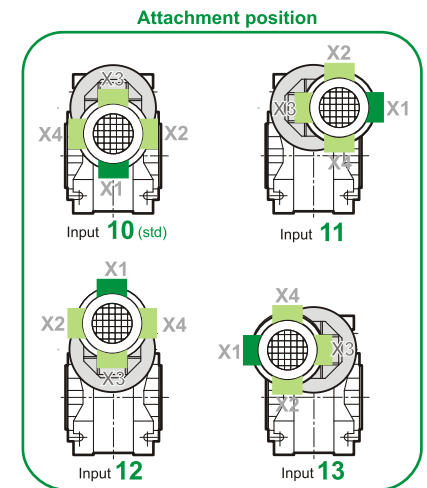
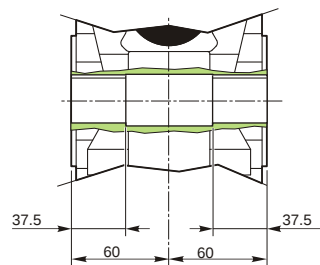

**Mounting positions**

**B3**

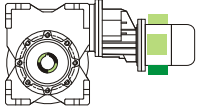

**B6**

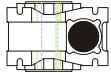

**B7**

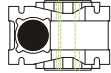

**B8**

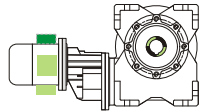

**V5**

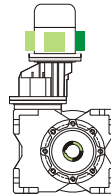

**V6**



Terminal box position

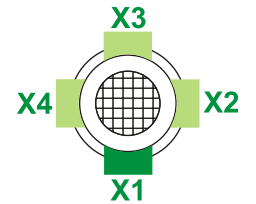

0.1	1	2	1
0.35	2	1	1

← Oil quantity [litres]

Lubricant type: Long life synthetic oil ISO VG320

**Direction of rotation**

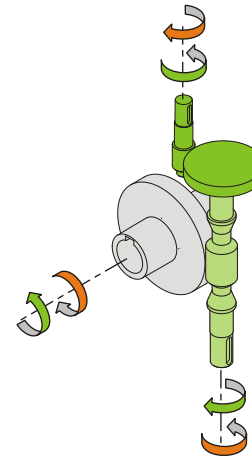
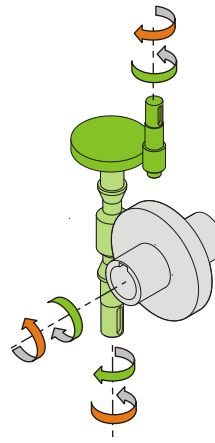
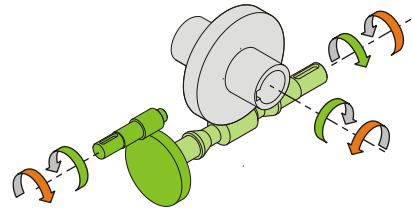
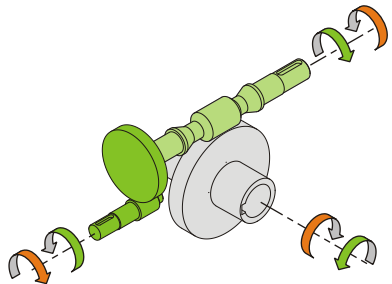

**Weight**

Gear unit [kg]	13
Electric motor [kg]	9.8

**Gearing data**

Axial module	2.8
Number of starts	2
Lead angle	11° 18'
Pressure angle	20°

**Backdriving**

Variable static self-locking  
Quick back-driving in case of vibrations  
Dynamic back-driving

**M TA 80/70 B3 10 128 80 B5 AC 28 MT 0.55 kW 80 A4 B5 X3**