

### Input data

System of measurement		Metric
Input type		Gear motor
Input speed	[rpm]	1400
Output speed	[rpm]	7.81
Ratio (i=)		179.2
Frequency	[Hz]	50
Input options		IEC
Requested input power	[kW]	0.75
Service factor		0.9
Rated Power P1	[kW]	0.68

### Output data

<b>Gear unit</b>	<b>M TA 80/85 B3 10 179.2 80 B14 AC 32 MT 0.75 kW 80 B4 B14 X3</b>
------------------	--

Type		TA - Worm speed reducers
Input type		M
Size		80/85
Ratio (i=)		179.2
Gearbox ratio		28.00
Pre-stage ratio		6.40
Input flange		B14
Input speed	[rpm]	1400
Output speed	[rpm]	7.81
Rated output torque	[Nm]	550.08
Service Factor		0.9
Efficiency		0.6
Inertia moment	[kgm <sup>2</sup> ]	0.000264

#### Gear unit configuration

Output shaft		Hollow output shaft
Fixing		Universal
Version		B3
Attachment position		10

#### Output radial and axial loads

Ball bearings output radial load	[N]	8300
Taper bearings output radial load	[N]	9400
Ball bearings output axial load	[N]	1660
Taper bearings output axial load	[N]	1880

#### Accessories

Hollow output shaft		AC 32
---------------------	--	-------

#### Electric motor

Size		80 B4
Poles		4
Power	[kW]	0.75

#### Electric motor configuration

Motor flange		B14
Terminal box position		X3

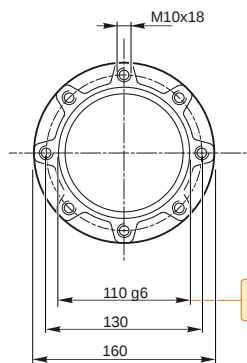
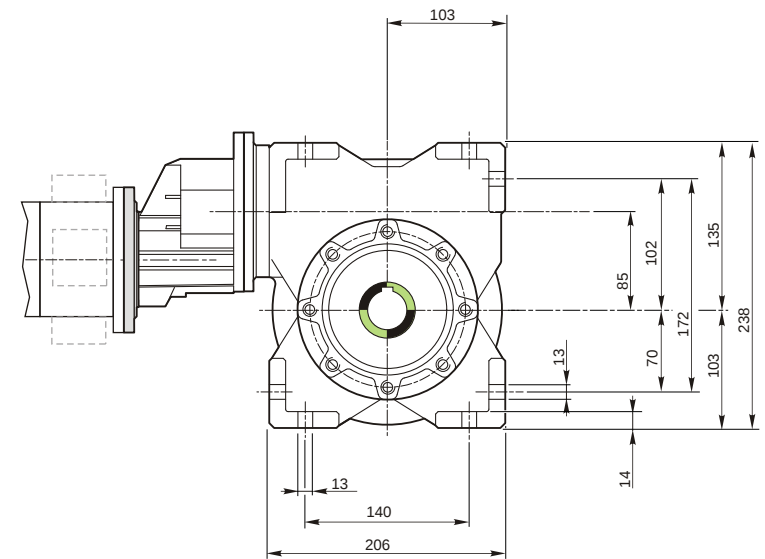
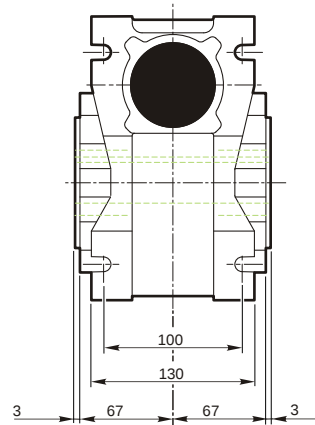
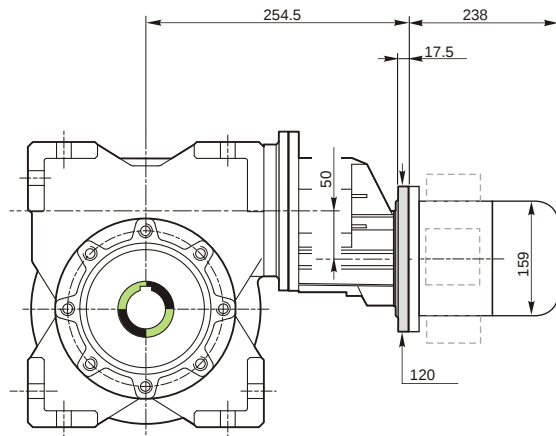

109.988  
109.966

Hollow output shaft

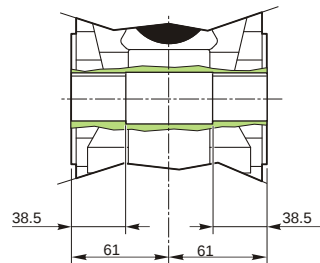
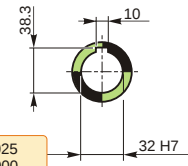

Attachment position

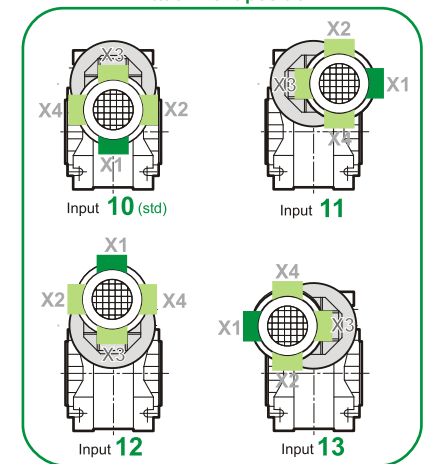

**M TA 80/85 B3 10 179.2 80 B14 AC 32 MT 0.75 kW 80 B4 B14 X3**

**Mounting positions**

**B3**

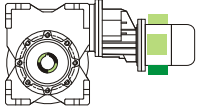

**B6**

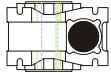

**B7**

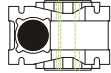

**B8**

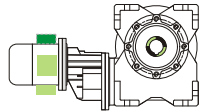

**V5**

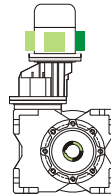

**V6**



Terminal box position

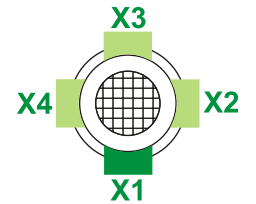

0.1	1	2	1
0.6	2	1	1

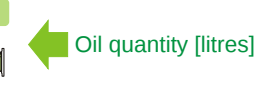

Lubricant type: Long life synthetic oil ISO VG320

**Direction of rotation**

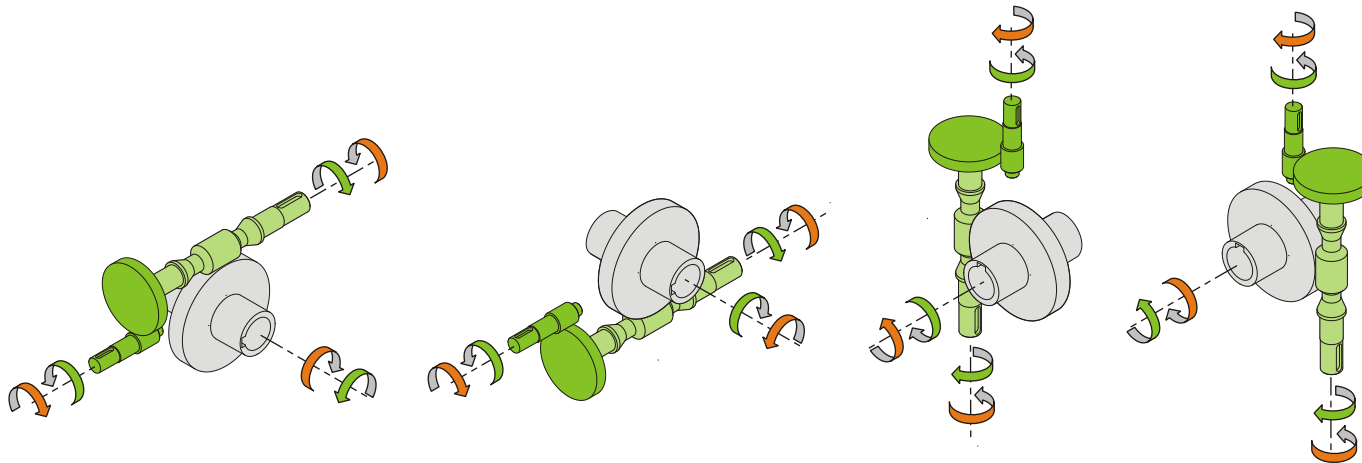

**Weight**

Gear unit [kg]	17.5
Electric motor [kg]	9.8

**Gearing data**

Axial module	4.7
Number of starts	1
Lead angle	6° 58'
Pressure angle	20°

**Backdriving**

Static self-locking  
Slow back-driving in case of vibrations  
Low dynamic back-driving

**M TA 80/85 B3 10 179.2 80 B14 AC 32 MT 0.75 kW 80 B4 B14 X3**