

Input data

| | | |
|-----------------------|-------|------------|
| System of measurement | | Metric |
| Input type | | Gear motor |
| Input speed | [rpm] | 1400 |
| Output speed | [rpm] | 32.1 |
| Ratio (i=) | | 43.61 |
| Frequency | [Hz] | 50 |
| Input options | | IEC |
| Requested input power | [kW] | 1.5 |
| Service factor | | 2.8 |
| Rated Power P1 | [kW] | 4.27 |

Output data

| | |
|------------------|---|
| Gear unit | M TA 100/110 B3 10 43.61 90 B14 AC 42 MT 1.5 kW 90 L4 B14 X3 |
|------------------|---|

| | | |
|---------------------|-------|--------------------------|
| Type | | TA - Worm speed reducers |
| Input type | | M |
| Size | | 100/110 |
| Ratio (i=) | | 43.61 |
| Gearbox ratio | | 7.00 |
| Pre-stage ratio | | 6.23 |
| Input flange | | B14 |
| Input speed | [rpm] | 1400 |
| Output speed | [rpm] | 32.1 |
| Rated output torque | [Nm] | 361.44 |
| Service Factor | | 2.8 |
| Efficiency | | 0.81 |

Gear unit configuration

| | | |
|---------------------|--|---------------------|
| Output shaft | | Hollow output shaft |
| Fixing | | Universal |
| Version | | B3 |
| Attachment position | | 10 |

Output radial and axial loads

| | | |
|-----------------------------------|-----|------|
| Ball bearings output radial load | [N] | 7150 |
| Taper bearings output radial load | [N] | 9950 |
| Ball bearings output axial load | [N] | 1430 |
| Taper bearings output axial load | [N] | 1990 |

Accessories

| | | |
|---------------------|--|-------|
| Hollow output shaft | | AC 42 |
|---------------------|--|-------|

Electric motor

| | | |
|-------|------|-------|
| Size | | 90 L4 |
| Poles | | 4 |
| Power | [kW] | 1.5 |

Electric motor configuration

| | | |
|-----------------------|--|-----|
| Motor flange | | B14 |
| Terminal box position | | X3 |

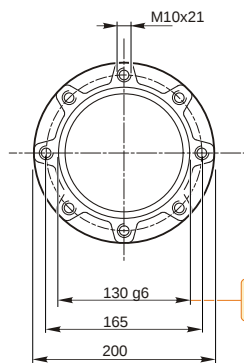
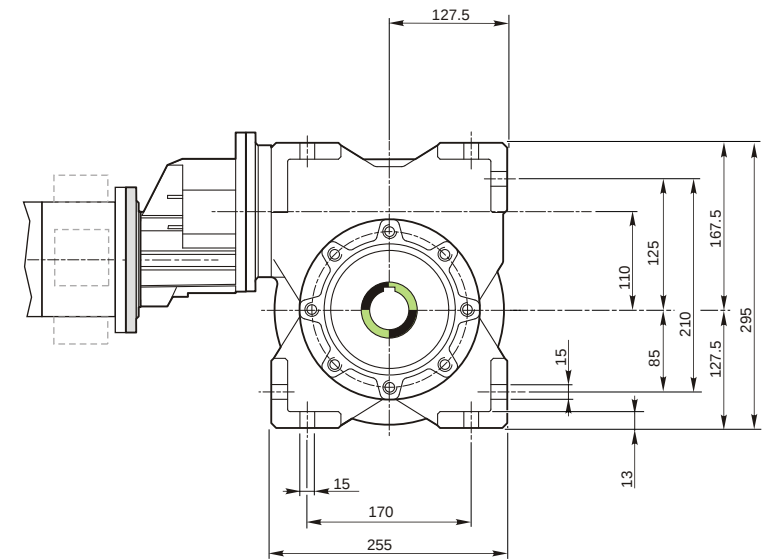
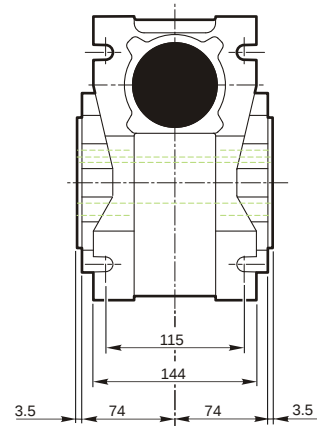
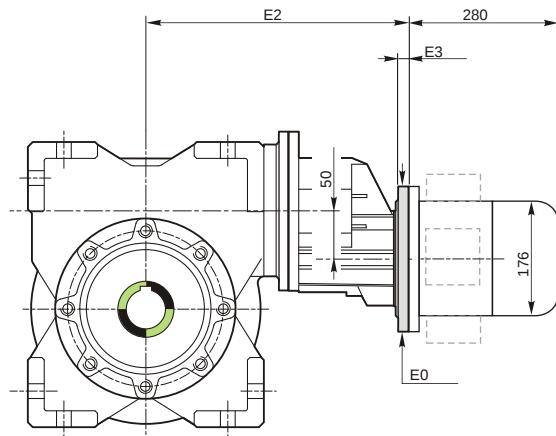

129.986
129.961

Hollow output shaft

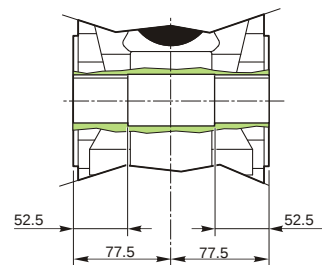
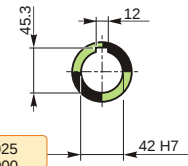

Attachment position

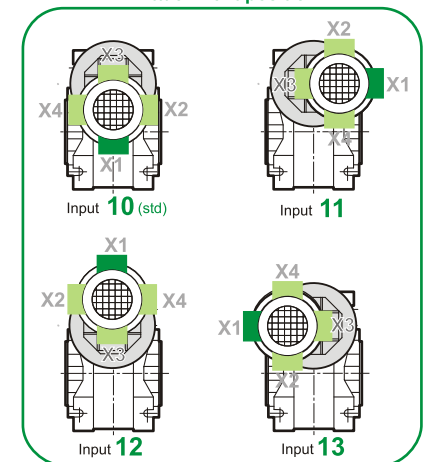

M TA 100/110 B3 10 43.61 90 B14 AC 42 MT 1.5 kW 90 L4 B14 X3

Mounting positions

B3

B6

B7

B8

V5

V6

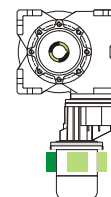
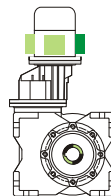
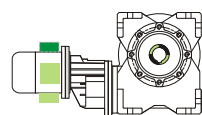
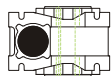
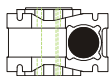
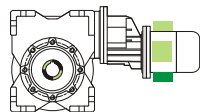

Terminal box position

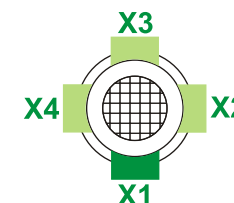

0.2

1

1.5

2



← Oil quantity [litres]

Lubricant type: Long life synthetic oil ISO VG320

Direction of rotation

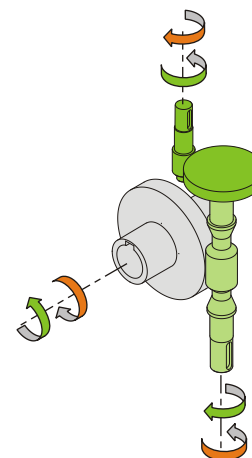
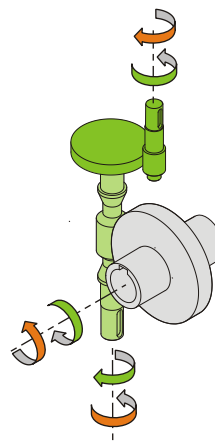
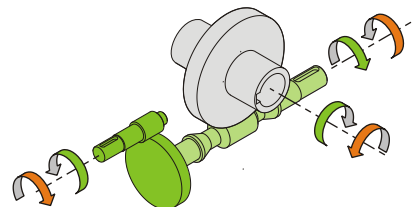
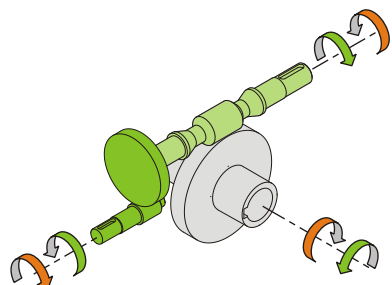

Weight

| | |
|---------------------|------|
| Gear unit [kg] | 46 |
| Electric motor [kg] | 13.5 |

Gearing data

| | |
|------------------|--------|
| Axial module | 6.1 |
| Number of starts | 4 |
| Lead angle | 6° 22' |
| Pressure angle | 20° |

Backdriving

Static back-driving
Quick back-driving
Dynamic back-driving

M TA 100/110 B3 10 43.61 90 B14 AC 42 MT 1.5 kW 90 L4 B14 X3