

### Input data

System of measurement		Metric
Input type		Gear motor
Input speed	[rpm]	1400
Output speed	[rpm]	2.38
Ratio (i=)		588
Frequency	[Hz]	50
Input options		IEC
Requested input power	[kW]	1.1
Service factor		1
Rated Power P1	[kW]	1.07

### Output data

<b>Gear unit</b>	<b>M RA 100/150 PC 10 588 90 B14 AC 55 MT 1.1 kW 90 S4 B14 X3 B3</b>
------------------	--

Type		RA - Worm speed reducers
Input type		M
Size		100/150
Ratio (i=)		588
Gearbox ratio		70.00
Pre-stage ratio		8.40
Input flange		B14
Mounting position		B3
Input speed	[rpm]	1400
Output speed	[rpm]	2.38
Rated output torque	[Nm]	2161.93
Service Factor		1
Efficiency		0.49

#### Gear unit configuration

Output shaft		Hollow output shaft
Fixing		Shaft mounting
Version		PC
Attachment position		10

#### Output radial and axial loads

Ball bearings output radial load	[N]	16500
Taper bearings output radial load	[N]	19500
Ball bearings output axial load	[N]	3300
Taper bearings output axial load	[N]	3900

#### Accessories

Hollow output shaft		AC 55
---------------------	--	-------

#### Electric motor

Size		90 S4
Poles		4
Power	[kW]	1.1

#### Electric motor configuration

Motor flange		B14
Terminal box position		X3

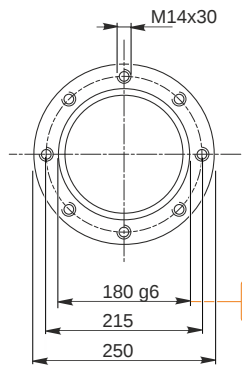
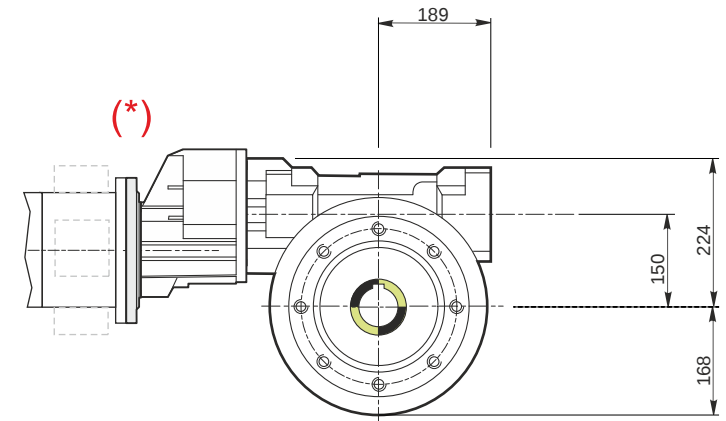
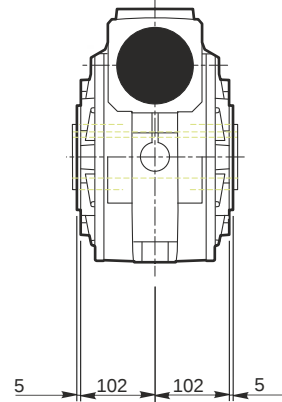
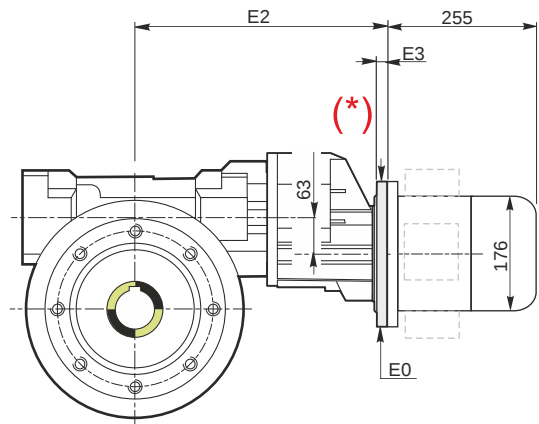

Hollow output shaft

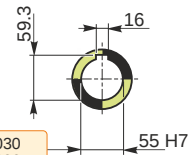

179.986  
179.961

55.030  
55.000

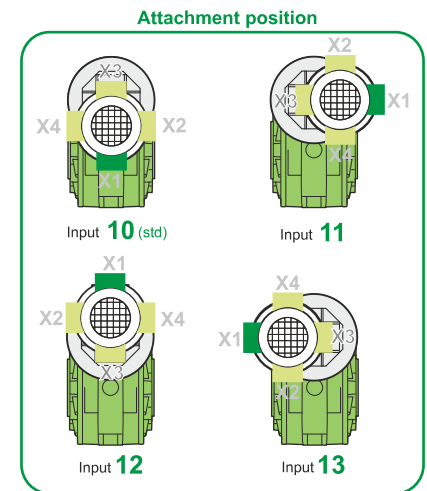
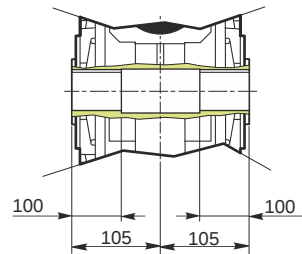

### Mounting positions

B3

B6

B7

B8

V5

V6

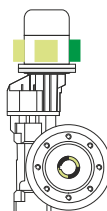
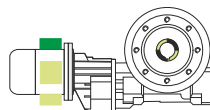
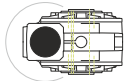
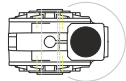
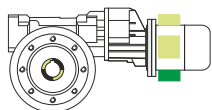

Terminal box position

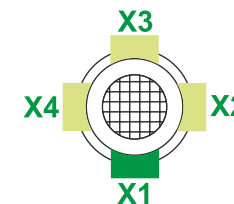

0.2	1
4.4	2

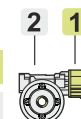

← Oil quantity [litres]

Lubricant type: Long life synthetic oil ISO VG320

### Direction of rotation

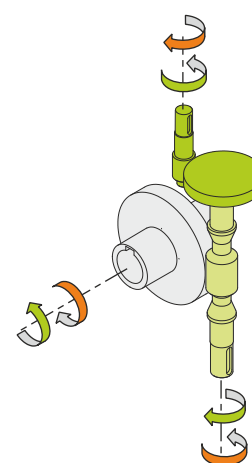
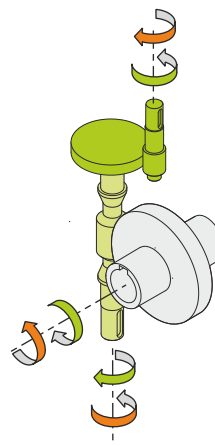
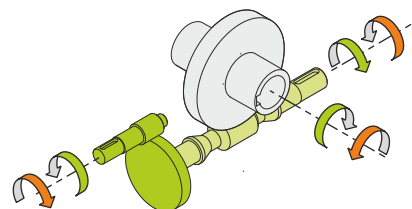
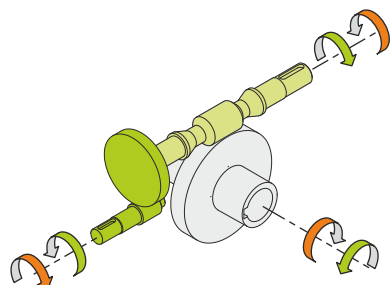

### Weight

Gear unit [kg]	94
Electric motor [kg]	12

### Gearing data

Axial module	3.60
Number of starts	1
Lead angle	4° 17'
Pressure angle	20°

### Backdriving

Static self-locking  
Slow back-driving in case of vibrations  
Low dynamic back-driving

**M RA 100/150 PC 10 588 90 B14 AC 55 MT 1.1 kW 90 S4 B14 X3 B3**